

Specifications

- Current rating:7A AC,DC
- Voltage rating:600V AC,DC
- Temperature range:-40°C~+105°C
- Contact resistance:10mΩMax.
- Insulation resistance:1000MΩMin.
- Withstanding voltage:1500V AC/minute
- *Compliant with RoHS and REACH*
- *Meet the HF/Halogen Free,GWT/Glow wire Test (IEC60335-1) request,need to customize*
- *Contact CJT for details*

Standards



Assembly layout

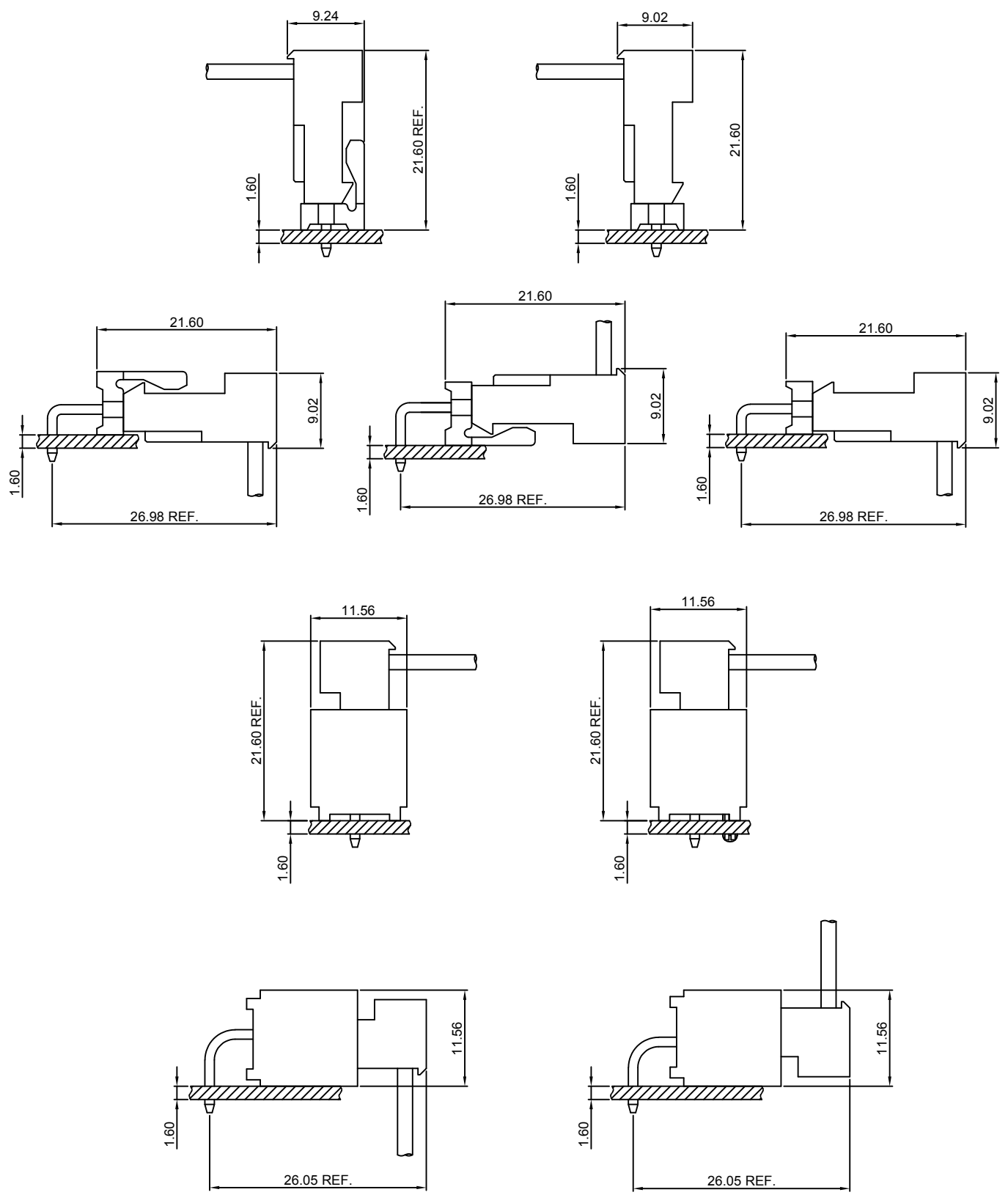

D3961H-XP

3.96mm IDC Closed End Type

Reference Informations:

*Material:

Terminal: Phosphor bronze

Housing: Nylon 66, UL94V-2 or UL94V-0

*Mates with CJT D3961WV, WR-XP(-A), D3961WR-XP-2(-A), D3961WV-XP-H(-A), D3961WVD, WRD-XP, D3961WVD-F-XP, D3961WRD-XP-2 series Wafer and D3961L-XP series Covers

Ordering Information:

D3961H-XP - ** - **
1 2 3

1: Part No.

2: Material:

OR-Orange=18 AWG(UL94V-2)

YL-Yellow=20 AWG(UL94V-2)

RD-Red=22 AWG(UL94V-2)

WH-White=24 AWG(UL94V-2)

BL-Blue=26 AWG(UL94V-2)

BK-18-Black=18 AWG(UL94V-0)

BK-20-Black=20 AWG(UL94V-0)

BK-22-Black=22 AWG(UL94V-0)

BK-24-Black=24 AWG(UL94V-0)

BK-26-Black=26 AWG(UL94V-0)

3: Plating Code:

(Blank)-Phosphor bronze/Tin over Nickel

GP-Phosphor bronze/Gold over Nickel

(Optional Gold plating available but MOQ requested)

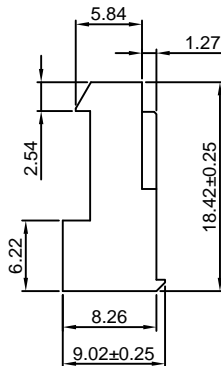
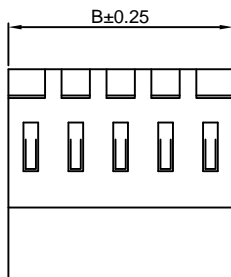
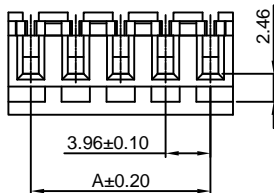

Ordering Information & Dimensions:

PART NO.	Dimensions	
	A	B
2P	3.96	7.92
3P	7.92	11.88
4P	11.88	15.84
5P	15.84	19.80
6P	19.80	23.76
7P	23.76	27.72
8P	27.72	31.68
9P	31.68	35.64
10P	35.64	39.60
11P	39.60	43.56
12P	43.56	47.52
13P	47.52	51.48
14P	51.48	55.44
15P	55.44	59.40
16P	59.40	63.36
17P	63.36	67.32
18P	67.32	71.28
19P	71.28	75.24
20P	75.24	79.20
21P	79.20	83.16
22P	83.16	87.12
23P	87.12	91.08
24P	91.08	95.04

Unit: mm

D3961HA-XP

3.96mm IDC Closed End Type

Reference Informations:

*Material:

Terminal: Phosphor bronze

Housing: Nylon 66, UL94V-2 or UL94V-0

*Mates with CJT D3961WV, WR-XP(-A), D3961WR-XP-2(-A), D3961WV-XP-H(-A), D3961WVD, WRD-XP, D3961WVD-F-XP, D3961WRD-XP-2 series Wafer and D3961L-XP series Covers

Ordering Information:

D3961HA-XP - ** - **
1 2 3

1: Part No.

2: Material:

OR-Orange=18 AWG(UL94V-2)

YL-Yellow=20 AWG(UL94V-2)

RD-Red=22 AWG(UL94V-2)

WH-White=24 AWG(UL94V-2)

BL-Blue=26 AWG(UL94V-2)

BK-18-Black=18 AWG(UL94V-0)

BK-20-Black=20 AWG(UL94V-0)

BK-22-Black=22 AWG(UL94V-0)

BK-24-Black=24 AWG(UL94V-0)

BK-26-Black=26 AWG(UL94V-0)

3: Plating Code:

(Blank)-Phosphor bronze/Tin over Nickel

GP-Phosphor bronze/Gold over Nickel

(Optional Gold plating available but MOQ requested)

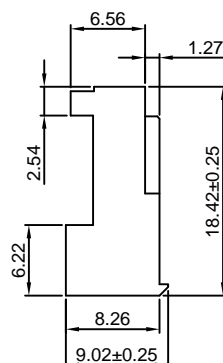
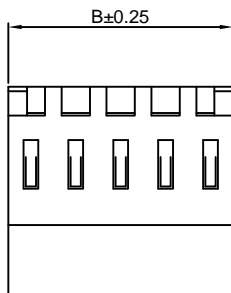
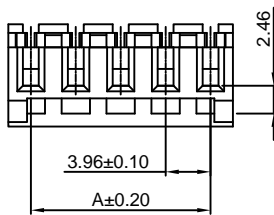

Ordering Information & Dimensions:

PART NO.	Dimensions	
	A	B
2P	3.96	7.92
3P	7.92	11.88
4P	11.88	15.84
5P	15.84	19.80
6P	19.80	23.76
7P	23.76	27.72
8P	27.72	31.68
9P	31.68	35.64
10P	35.64	39.60
11P	39.60	43.56
12P	43.56	47.52
13P	47.52	51.48
14P	51.48	55.44
15P	55.44	59.40
16P	59.40	63.36
17P	63.36	67.32
18P	67.32	71.28
19P	71.28	75.24
20P	75.24	79.20
21P	79.20	83.16
22P	83.16	87.12
23P	87.12	91.08
24P	91.08	95.04

Unit: mm

D3961HB-XP

3.96mm IDC Feed-Thru Connector

Reference Informations:

- *Material:
 - Terminal: Phosphor bronze
 - Housing: Nylon 66, UL94V-2 or UL94V-0
- *Mates with CJT D3961WV, WR-XP(-A), D3961WR-XP-2(-A), D3961WV-XP-H(-A), D3961WVD, WRD-XP, D3961WVD-F-XP, D3961WRD-XP-2 series Wafer and D3961C-XP series Covers

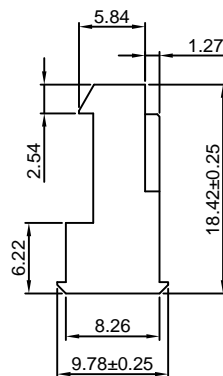
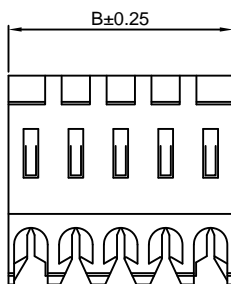
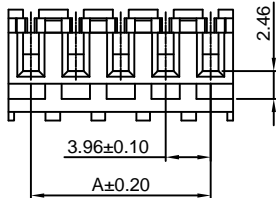

Ordering Information:

D3961HB-XP - ** - **
 1 2 3

- 1: Part No.
- 2: Material:
 - OR-Orange=18 AWG(UL94V-2)
 - YL-Yellow=20 AWG(UL94V-2)
 - RD-Red=22 AWG(UL94V-2)
 - WH-White=24 AWG(UL94V-2)
 - BL-Blue=26 AWG(UL94V-2)
 - BK-18-Black=18 AWG(UL94V-0)
 - BK-20-Black=20 AWG(UL94V-0)
 - BK-22-Black=22 AWG(UL94V-0)
 - BK-24-Black=24 AWG(UL94V-0)
 - BK-26-Black=26 AWG(UL94V-0)
- 3: Plating Code:
 - (Blank)-Phosphor bronze/Tin over Nickel
 - GP-Phosphor bronze/Gold over Nickel
(Optional Gold plating available but MOQ requested)

Ordering Information & Dimensions:

PART NO.	Dimensions	
	A	B
2P	3.96	7.92
3P	7.92	11.88
4P	11.88	15.84
5P	15.84	19.80
6P	19.80	23.76
7P	23.76	27.72
8P	27.72	31.68
9P	31.68	35.64
10P	35.64	39.60
11P	39.60	43.56
12P	43.56	47.52
13P	47.52	51.48
14P	51.48	55.44
15P	55.44	59.40
16P	59.40	63.36
17P	63.36	67.32
18P	67.32	71.28
19P	71.28	75.24
20P	75.24	79.20
21P	79.20	83.16
22P	83.16	87.12
23P	87.12	91.08
24P	91.08	95.04

Unit: mm

D3961HC-XP

3.96mm IDC Feed-Thru Connector

Reference Informations:

- *Material:
 - Terminal: Phosphor bronze
 - Housing: Nylon 66, UL94V-2 or UL94V-0
- *Mates with CJT D3961WV, WR-XP(-A), D3961WR-XP-2(-A), D3961WV-XP-H(-A), D3961WVD, WRD-XP, D3961WVD-F-XP, D3961WRD-XP-2 series Wafer and D3961C-XP series Covers

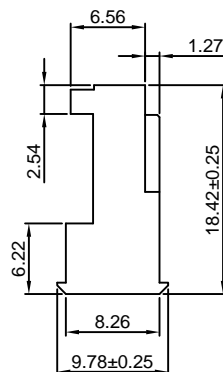
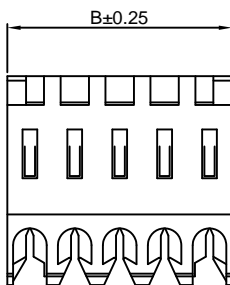
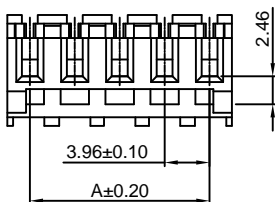

Ordering Information:

D3961HC-XP - ** - **
 1 2 3

- 1: Part No.
- 2: Material:
 - OR-Orange=18 AWG(UL94V-2)
 - YL-Yellow=20 AWG(UL94V-2)
 - RD-Red=22 AWG(UL94V-2)
 - WH-White=24 AWG(UL94V-2)
 - BL-Blue=26 AWG(UL94V-2)
 - BK-18-Black=18 AWG(UL94V-0)
 - BK-20-Black=20 AWG(UL94V-0)
 - BK-22-Black=22 AWG(UL94V-0)
 - BK-24-Black=24 AWG(UL94V-0)
 - BK-26-Black=26 AWG(UL94V-0)
- 3: Plating Code:
 - (Blank)-Phosphor bronze/Tin over Nickel
 - GP-Phosphor bronze/Gold over Nickel
(Optional Gold plating available but MOQ requested)

Ordering Information & Dimensions:

PART NO.	Dimensions	
	A	B
2P	3.96	7.92
3P	7.92	11.88
4P	11.88	15.84
5P	15.84	19.80
6P	19.80	23.76
7P	23.76	27.72
8P	27.72	31.68
9P	31.68	35.64
10P	35.64	39.60
11P	39.60	43.56
12P	43.56	47.52
13P	47.52	51.48
14P	51.48	55.44
15P	55.44	59.40
16P	59.40	63.36
17P	63.36	67.32
18P	67.32	71.28
19P	71.28	75.24
20P	75.24	79.20
21P	79.20	83.16
22P	83.16	87.12
23P	87.12	91.08
24P	91.08	95.04

Unit: mm

D3961HD-XP

3.96mm IDC Closed End Type

Reference Informations:

*Material:

Terminal: Phosphor bronze

Housing: Nylon 66, UL94V-2 or UL94V-0

*Mates with CJT D3961WVA, WRA, WRB-XP(-A), D3961WVA-XP-H(-A) series Wafer and D3961L-XP series Covers

Ordering Information:

D3961HD-XP - ^{**}/₂ - ^{**}/₃

1: Part No.

2: Material:

OR-Orange=18 AWG(UL94V-2)

YL-Yellow=20 AWG(UL94V-2)

RD-Red=22 AWG(UL94V-2)

WH-White=24 AWG(UL94V-2)

BL-Blue=26 AWG(UL94V-2)

BK-18-Black=18 AWG(UL94V-0)

BK-20-Black=20 AWG(UL94V-0)

BK-22-Black=22 AWG(UL94V-0)

BK-24-Black=24 AWG(UL94V-0)

BK-26-Black=26 AWG(UL94V-0)

3: Plating Code:

(Blank)-Phosphor bronze/Tin over Nickel

GP-Phosphor bronze/Gold over Nickel

(Optional Gold plating available but MOQ requested)

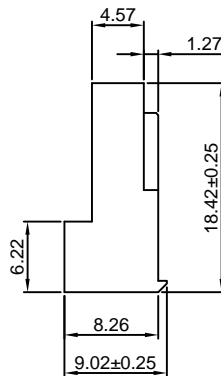
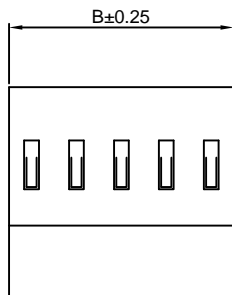
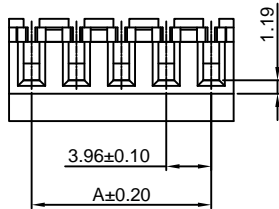

Ordering Information & Dimensions:

PART NO.	Dimensions	
	A	B
2P	3.96	7.92
3P	7.92	11.88
4P	11.88	15.84
5P	15.84	19.80
6P	19.80	23.76
7P	23.76	27.72
8P	27.72	31.68
9P	31.68	35.64
10P	35.64	39.60
11P	39.60	43.56
12P	43.56	47.52
13P	47.52	51.48
14P	51.48	55.44
15P	55.44	59.40
16P	59.40	63.36
17P	63.36	67.32
18P	67.32	71.28
19P	71.28	75.24
20P	75.24	79.20
21P	79.20	83.16
22P	83.16	87.12
23P	87.12	91.08
24P	91.08	95.04

Unit: mm

D3961HE-XP

3.96mm IDC Closed End Type

Reference Informations:

*Material:

Terminal: Phosphor bronze

Housing: Nylon 66, UL94V-2 or UL94V-0

*Mates with CJT D3961WV, WR-XP(-A), D3961WR-XP-2(-A), D3961WV-XP-H(-A), D3961WVD, WRD-XP, D3961WVD-F-XP, D3961WRD-XP-2 series Wafer and D3961L-XP series Covers

Ordering Information:

D3961HE-XP - ^{**}/₂ - ^{**}/₃

1: Part No.

2: Material:

OR-Orange=18 AWG(UL94V-2)

YL-Yellow=20 AWG(UL94V-2)

RD-Red=22 AWG(UL94V-2)

WH-White=24 AWG(UL94V-2)

BL-Blue=26 AWG(UL94V-2)

BK-18-Black=18 AWG(UL94V-0)

BK-20-Black=20 AWG(UL94V-0)

BK-22-Black=22 AWG(UL94V-0)

BK-24-Black=24 AWG(UL94V-0)

BK-26-Black=26 AWG(UL94V-0)

3: Plating Code:

(Blank)-Phosphor bronze/Tin over Nickel

GP-Phosphor bronze/Gold over Nickel

(Optional Gold plating available but MOQ requested)

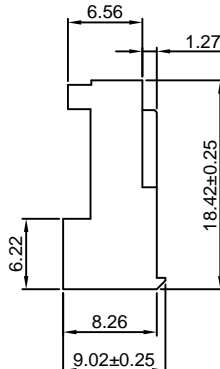
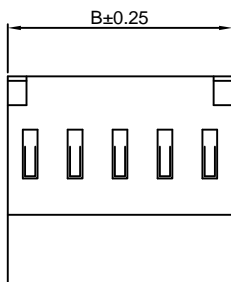
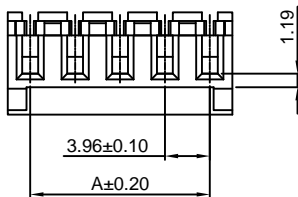

Ordering Information & Dimensions:

PART NO.	Dimensions	
	A	B
2P	3.96	7.92
3P	7.92	11.88
4P	11.88	15.84
5P	15.84	19.80
6P	19.80	23.76
7P	23.76	27.72
8P	27.72	31.68
9P	31.68	35.64
10P	35.64	39.60
11P	39.60	43.56
12P	43.56	47.52
13P	47.52	51.48
14P	51.48	55.44
15P	55.44	59.40
16P	59.40	63.36
17P	63.36	67.32
18P	67.32	71.28
19P	71.28	75.24
20P	75.24	79.20
21P	79.20	83.16
22P	83.16	87.12
23P	87.12	91.08
24P	91.08	95.04

Unit: mm

D3961HF-XP

3.96mm IDC Feed-Thru Connector

Reference Informations:

*Material:

Terminal: Phosphor bronze

Housing: Nylon 66, UL94V-2 or UL94V-0

*Mates with CJT D3961WVA, WRA, WRB-XP(-A), D3961WVA-XP-H(-A) series Wafer and D3961C-XP series Covers

Ordering Information:

D3961HF-XP - ** - **
1 2 3

1: Part No.

2: Material:

OR-Orange=18 AWG(UL94V-2)

YL-Yellow=20 AWG(UL94V-2)

RD-Red=22 AWG(UL94V-2)

WH-White=24 AWG(UL94V-2)

BL-Blue=26 AWG(UL94V-2)

BK-18-Black=18 AWG(UL94V-0)

BK-20-Black=20 AWG(UL94V-0)

BK-22-Black=22 AWG(UL94V-0)

BK-24-Black=24 AWG(UL94V-0)

BK-26-Black=26 AWG(UL94V-0)

3: Plating Code:

(Blank)-Phosphor bronze/Tin over Nickel

GP-Phosphor bronze/Gold over Nickel

(Optional Gold plating available but MOQ requested)

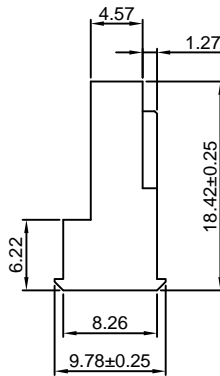
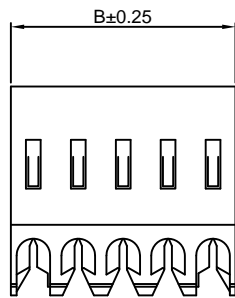
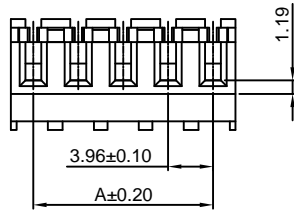

Ordering Information & Dimensions:

PART NO.	Dimensions	
	A	B
2P	3.96	7.92
3P	7.92	11.88
4P	11.88	15.84
5P	15.84	19.80
6P	19.80	23.76
7P	23.76	27.72
8P	27.72	31.68
9P	31.68	35.64
10P	35.64	39.60
11P	39.60	43.56
12P	43.56	47.52
13P	47.52	51.48
14P	51.48	55.44
15P	55.44	59.40
16P	59.40	63.36
17P	63.36	67.32
18P	67.32	71.28
19P	71.28	75.24
20P	75.24	79.20
21P	79.20	83.16
22P	83.16	87.12
23P	87.12	91.08
24P	91.08	95.04

Unit: mm

D3961HG-XP

3.96mm IDC Feed-Thru Connector

Reference Informations:

*Material:

Terminal: Phosphor bronze

Housing: Nylon 66, UL94V-2 or UL94V-0

*Mates with CJT D3961WV, WR-XP(-A), D3961WR-XP-2(-A), D3961WV-XP-H(-A), D3961WVD, WRD-XP, D3961WVD-F-XP, D3961WRD-XP-2 series Wafer and D3961C-XP series Covers

Ordering Information:

D3961HG-XP - ** - **
1 2 3

1: Part No.

2: Material:

OR-Orange=18 AWG(UL94V-2)

YL-Yellow=20 AWG(UL94V-2)

RD-Red=22 AWG(UL94V-2)

WH-White=24 AWG(UL94V-2)

BL-Blue=26 AWG(UL94V-2)

BK-18-Black=18 AWG(UL94V-0)

BK-20-Black=20 AWG(UL94V-0)

BK-22-Black=22 AWG(UL94V-0)

BK-24-Black=24 AWG(UL94V-0)

BK-26-Black=26 AWG(UL94V-0)

3: Plating Code:

(Blank)-Phosphor bronze/Tin over Nickel

GP-Phosphor bronze/Gold over Nickel

(Optional Gold plating available but MOQ requested)

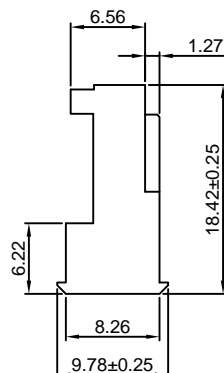
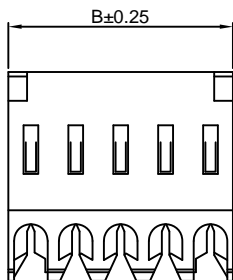
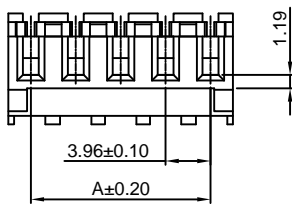

Ordering Information & Dimensions:

PART NO.	Dimensions	
	A	B
2P	3.96	7.92
3P	7.92	11.88
4P	11.88	15.84
5P	15.84	19.80
6P	19.80	23.76
7P	23.76	27.72
8P	27.72	31.68
9P	31.68	35.64
10P	35.64	39.60
11P	39.60	43.56
12P	43.56	47.52
13P	47.52	51.48
14P	51.48	55.44
15P	55.44	59.40
16P	59.40	63.36
17P	63.36	67.32
18P	67.32	71.28
19P	71.28	75.24
20P	75.24	79.20
21P	79.20	83.16
22P	83.16	87.12
23P	87.12	91.08
24P	91.08	95.04

Unit: mm

D3961HH-XP

3.96mm IDC Closed End Type

Reference Informations:

*Material:

Terminal: Phosphor bronze

Housing: Nylon 66, UL94V-2 or UL94V-0

*Mates with CJT D3961WV, WR-XP(-A), D3961WR-XP-2(-A), D3961WV-XP-H(-A), D3961WVD, WRD-XP, D3961WVD-F-XP, D3961WRD-XP-2 series Wafer and D3961L-XP series Covers

Ordering Information:

D3961HH-XP - ** - **
1 2 3

1: Part No.

2: Wire Range and Material:

2-22 AWG(UL94V-2)

4-24 AWG(UL94V-2)

6-26 AWG(UL94V-2)

8-28 AWG(UL94V-2)

3: Plating Code:

(Blank)-Phosphor bronze/Tin over Nickel

GP-Phosphor bronze/Gold over Nickel

(Optional Gold plating available but MOQ requested)

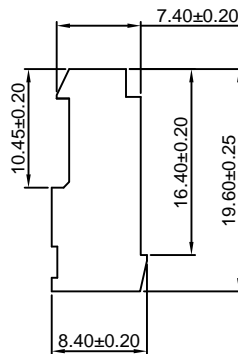
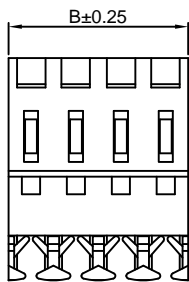
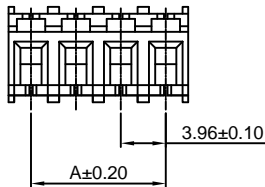

Ordering Information & Dimensions:

PART NO.	Dimensions	
	A	B
2P	3.96	7.92
3P	7.92	11.88
4P	11.88	15.84
5P	15.84	19.80
6P	19.80	23.76
7P	23.76	27.72
8P	27.72	31.68
9P	31.68	35.64
10P	35.64	39.60
11P	39.60	43.56
12P	43.56	47.52
13P	47.52	51.48
14P	51.48	55.44
15P	55.44	59.40
16P	59.40	63.36
17P	63.36	67.32
18P	67.32	71.28
19P	71.28	75.24
20P	75.24	79.20

Unit: mm

D3961HI-XP

3.96mm IDC Closed End Type

Reference Informations:

*Material:

Terminal: Phosphor bronze

Housing: Nylon 66, UL94V-2 or UL94V-0

*Mates with CJT D3961WV, WR-XP(-A), D3961WR-XP-2(-A), D3961WV-XP-H(-A), D3961WVD, WRD-XP, D3961WVD-F-XP, D3961WRD-XP-2 series Wafer and D3961L-XP series Covers

Ordering Information:

D3961HI-XP - ** - **
1 2 3

1: Part No.

2: Wire Range and Material:

2-22 AWG(UL94V-2)

4-24 AWG(UL94V-2)

6-26 AWG(UL94V-2)

8-28 AWG(UL94V-2)

3: Plating Code:

(Blank)-Phosphor bronze/Tin over Nickel

GP-Phosphor bronze/Gold over Nickel

(Optional Gold plating available but MOQ requested)

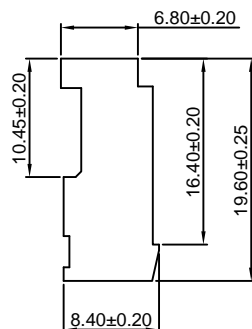
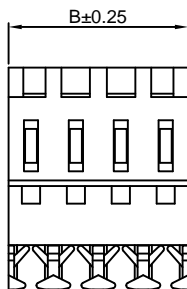
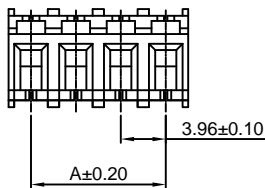

Ordering Information & Dimensions:

PART NO.	Dimensions	
	A	B
2P	3.96	7.92
3P	7.92	11.88
4P	11.88	15.84
5P	15.84	19.80
6P	19.80	23.76
7P	23.76	27.72
8P	27.72	31.68
9P	31.68	35.64
10P	35.64	39.60
11P	39.60	43.56
12P	43.56	47.52
13P	47.52	51.48
14P	51.48	55.44
15P	55.44	59.40
16P	59.40	63.36
17P	63.36	67.32
18P	67.32	71.28
19P	71.28	75.24
20P	75.24	79.20

Unit: mm

D3961HJ-XP

3.96mm IDC Feed-Thru Connector

Reference Informations:

*Material:

Terminal: Phosphor bronze

Housing: Nylon 66, UL94V-2 or UL94V-0

*Mates with CJT D3961WV, WR-XP(-A), D3961WR-XP-2(-A), D3961WV-XP-H(-A), D3961WVD, WRD-XP, D3961WVD-F-XP, D3961WRD-XP-2 series Wafer and D3961C-XP series Covers

Ordering Information:

D3961HJ-XP - ** - **
1 2 3

1: Part No.

2: Wire Range and Material:

2-22 AWG(UL94V-2)

4-24 AWG(UL94V-2)

6-26 AWG(UL94V-2)

8-28 AWG(UL94V-2)

3: Plating Code:

(Blank)-Phosphor bronze/Tin over Nickel

GP-Phosphor bronze/Gold over Nickel

(Optional Gold plating available but MOQ requested)

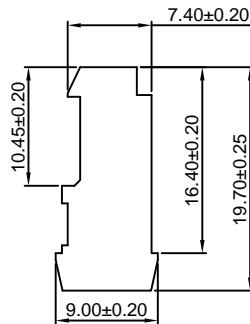
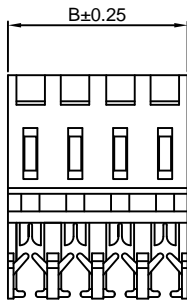
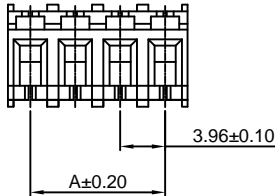

Ordering Information & Dimensions:

PART NO.	Dimensions	
	A	B
2P	3.96	7.92
3P	7.92	11.88
4P	11.88	15.84
5P	15.84	19.80
6P	19.80	23.76
7P	23.76	27.72
8P	27.72	31.68
9P	31.68	35.64
10P	35.64	39.60
11P	39.60	43.56
12P	43.56	47.52
13P	47.52	51.48
14P	51.48	55.44
15P	55.44	59.40
16P	59.40	63.36
17P	63.36	67.32
18P	67.32	71.28
19P	71.28	75.24
20P	75.24	79.20

Unit: mm

D3961HK-XP

3.96mm IDC Feed-Thru Connector

Reference Informations:

*Material:

Terminal: Phosphor bronze

Housing: Nylon 66, UL94V-2 or UL94V-0

*Mates with CJT D3961WV, WR-XP(-A), D3961WR-XP-2(-A), D3961WV-XP-H(-A), D3961WVD, WRD-XP, D3961WVD-F-XP, D3961WRD-XP-2 series Wafer and D3961C-XP series Covers

Ordering Information:

D3961HK-XP - ** - **
1 2 3

1: Part No.

2: Wire Range and Material:

2-22 AWG(UL94V-2)

4-24 AWG(UL94V-2)

6-26 AWG(UL94V-2)

8-28 AWG(UL94V-2)

3: Plating Code:

(Blank)-Phosphor bronze/Tin over Nickel

GP-Phosphor bronze/Gold over Nickel

(Optional Gold plating available but MOQ requested)

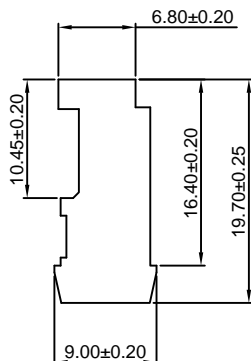
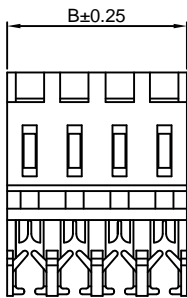
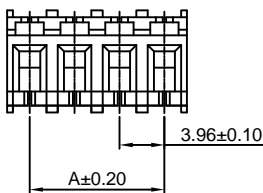

Ordering Information & Dimensions:

PART NO.	Dimensions	
	A	B
2P	3.96	7.92
3P	7.92	11.88
4P	11.88	15.84
5P	15.84	19.80
6P	19.80	23.76
7P	23.76	27.72
8P	27.72	31.68
9P	31.68	35.64
10P	35.64	39.60
11P	39.60	43.56
12P	43.56	47.52
13P	47.52	51.48
14P	51.48	55.44
15P	55.44	59.40
16P	59.40	63.36
17P	63.36	67.32
18P	67.32	71.28
19P	71.28	75.24
20P	75.24	79.20

Unit: mm

D3961C-XP

3.96mm Feed-Thru Strain Relief Covers

Reference Informations:

- *Material:Nylon 66, UL94V-2
- *Mates with CJT D3961HB,HC, HF,HG,HJ,HK-XP series Housing
- *Color:Natural(White)

Ordering Information:

- D3961C-XP - ***
 1 2
- 1.Part No.
 - 2.Material:
 (blank):Nylon 66,UL94V-2
GWT:Nylon 66,UL94V-0,GWT 750°C

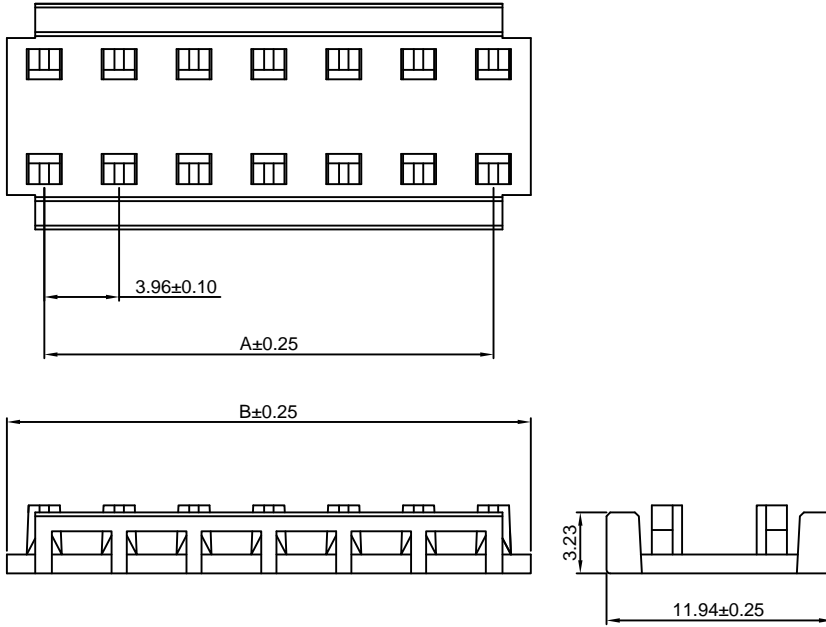

Ordering Information & Dimensions:

PART NO.	Dimensions	
	A	B
2P	3.96	7.92
3P	7.92	11.88
4P	11.88	15.84
5P	15.84	19.80
6P	19.80	23.76
7P	23.76	27.72
8P	27.72	31.68
9P	31.68	35.64
10P	35.64	39.60
11P	39.60	43.56
12P	43.56	47.52
13P	47.52	51.48
14P	51.48	55.44
15P	55.44	59.40
16P	59.40	63.36
17P	63.36	67.32
18P	67.32	71.28
19P	71.28	75.24
20P	75.24	79.20
21P	79.20	83.16
22P	83.16	87.12
23P	87.12	91.08
24P	91.08	95.04

Unit: mm

D3961L-XP

3.96mm IDC Closed End Strain Relief Covers

Reference Informations:

- *Material:Nylon 66, UL94V-2
- *Mates with CJT D3961H,HA,HD, HE,HH,HI-XP series Housing
- *Color:Natural(White)

Ordering Information:

- D3961L-XP - ***
 1 2
- 1.Part No.
 - 2.Material:
 (blank):Nylon 66,UL94V-2
GWT:Nylon 66,UL94V-0,GWT 750°C

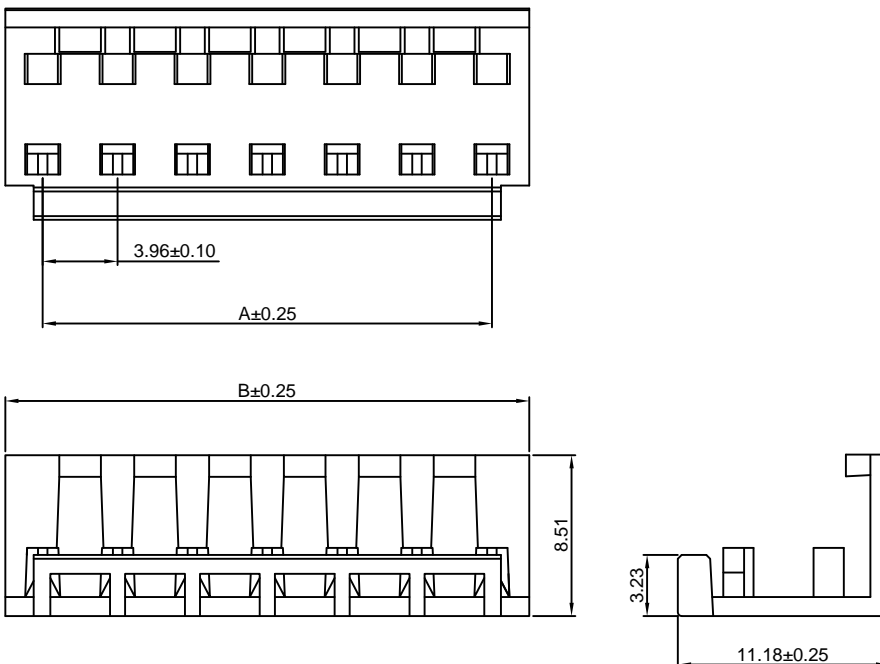

Ordering Information & Dimensions:

PART NO.	Dimensions	
	A	B
2P	3.96	7.92
3P	7.92	11.88
4P	11.88	15.84
5P	15.84	19.80
6P	19.80	23.76
7P	23.76	27.72
8P	27.72	31.68
9P	31.68	35.64
10P	35.64	39.60
11P	39.60	43.56
12P	43.56	47.52
13P	47.52	51.48
14P	51.48	55.44
15P	55.44	59.40
16P	59.40	63.36
17P	63.36	67.32
18P	67.32	71.28
19P	71.28	75.24
20P	75.24	79.20
21P	79.20	83.16
22P	83.16	87.12
23P	87.12	91.08
24P	91.08	95.04

Unit: mm

D3961WV-XP

3.96mm pitch 180° Wafer

Reference Informations:

- *Material: Pin: Brass/Tin over Nickel
Insulator: Nylon 66, UL94V-0
- *Mates with CJT D3961H, HA, HB, HC, HE, HG, HH, HI, HJ, HK-XP series Housing
- *Color: Natural

Ordering Information:
D3961WV-XP - * - *** - ***
1 2 3 4

1. Part No.
2. Type:
(Blank): TYPE 1
L: TYPE 2
3. Material:
(blank): Nylon 66, UL94V-0
GWT: Nylon 66, UL94V-0, GWT 750°C
4. Finish:
(blank): Tin over Nickel
G: Gold-flash
G30: 30µin (0.76µm) MIN. Select Gold (Mating Area)
100µin (2.54µm) MIN. Select Tin

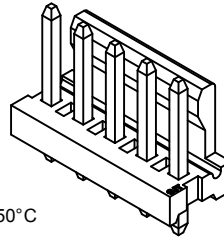

Ordering Information & Dimensions:

PART NO.	Dimensions	
	A	B
2P	3.96	7.92
3P	7.92	11.88
4P	11.88	15.84
5P	15.84	19.80
6P	19.80	23.76
7P	23.76	27.72
8P	27.72	31.68
9P	31.68	35.64
10P	35.64	39.60
11P	39.60	43.56
12P	43.56	47.52
13P	47.52	51.48
14P	51.48	55.44
15P	55.44	59.40
16P	59.40	63.36
17P	63.36	67.32
18P	67.32	71.28
19P	71.28	75.24
20P	75.24	79.20
21P	79.20	83.16
22P	83.16	87.12
23P	87.12	91.08
24P	91.08	95.04

Unit: mm

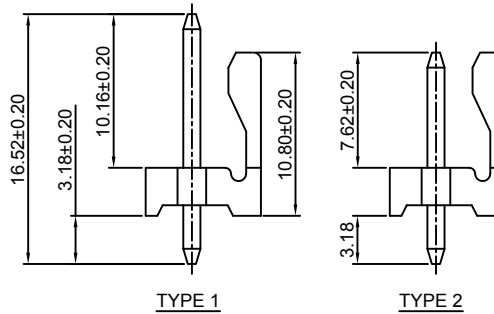
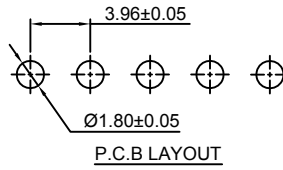
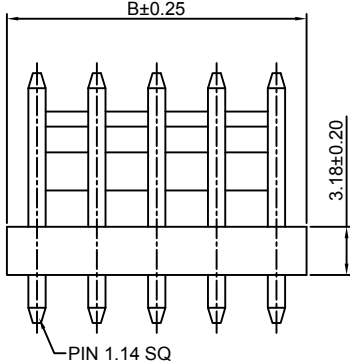
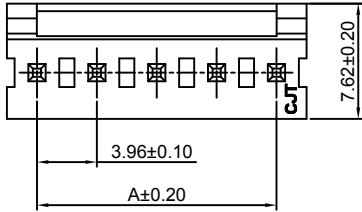

D3961WV-XP-H

3.96mm pitch 180° Wafer

Reference Informations:

- *Material: Pin: Brass/Tin over Nickel
Insulator: Nylon 66, UL94V-0
- *Mates with CJT D3961H, HA, HB, HC, HE, HG, HH, HI, HJ, HK-XP series Housing
- *Color: Natural

Ordering Information:
D3961WV-XP-H - * - *** - ***
1 2 3 4

1. Part No.
2. Type:
(Blank): TYPE 1
L: TYPE 2
3. Material:
(blank): Nylon 66, UL94V-0
GWT: Nylon 66, UL94V-0, GWT 750°C
4. Finish:
(blank): Tin over Nickel
G: Gold-flash
G30: 30µin (0.76µm) MIN. Select Gold (Mating Area)
100µin (2.54µm) MIN. Select Tin

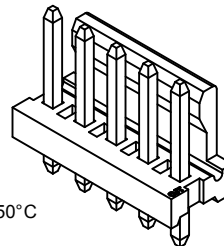

Ordering Information & Dimensions:

PART NO.	Dimensions	
	A	B
2P	3.96	7.92
3P	7.92	11.88
4P	11.88	15.84
5P	15.84	19.80
6P	19.80	23.76
7P	23.76	27.72
8P	27.72	31.68
9P	31.68	35.64
10P	35.64	39.60
11P	39.60	43.56
12P	43.56	47.52
13P	47.52	51.48
14P	51.48	55.44
15P	55.44	59.40
16P	59.40	63.36
17P	63.36	67.32
18P	67.32	71.28
19P	71.28	75.24
20P	75.24	79.20
21P	79.20	83.16
22P	83.16	87.12
23P	87.12	91.08
24P	91.08	95.04

Unit: mm

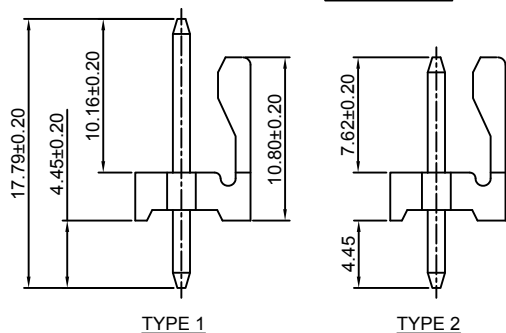
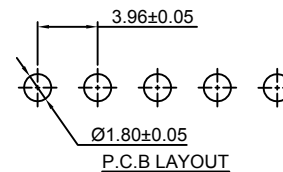
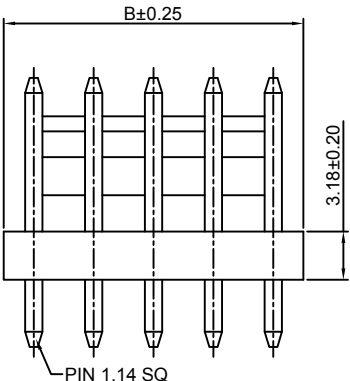
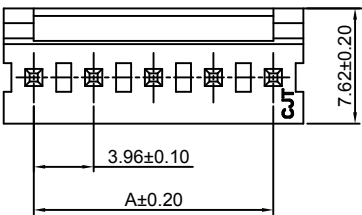

D3961WVA-XP

3.96mm pitch 180° Wafer

Reference Informations:

- *Material: Pin: Brass/Tin over Nickel
Insulator: Nylon 66, UL94V-0
- *Mates with CJT D3961HD, HF-XP series Housing
- *Color: Natural

Ordering Information:
 $\frac{D3961WVA-XP}{1} - \frac{*}{2} - \frac{***}{3} - \frac{***}{4}$

1. Part No.
2. Type:
(Blank): TYPE 1
L: TYPE 2
3. Material:
(blank): Nylon 66, UL94V-0
GWT: Nylon 66, UL94V-0, GWT 750°C
4. Finish:
(blank): Tin over Nickel
G: Gold-flash
G30: 30µin (0.76µm) MIN. Select Gold (Mating Area)
100µin (2.54µm) MIN. Select Tin

Ordering Information & Dimensions:

PART NO.	Dimensions	
	A	B
2P	3.96	7.92
3P	7.92	11.88
4P	11.88	15.84
5P	15.84	19.80
6P	19.80	23.76
7P	23.76	27.72
8P	27.72	31.68
9P	31.68	35.64
10P	35.64	39.60
11P	39.60	43.56
12P	43.56	47.52
13P	47.52	51.48
14P	51.48	55.44
15P	55.44	59.40
16P	59.40	63.36
17P	63.36	67.32
18P	67.32	71.28
19P	71.28	75.24
20P	75.24	79.20
21P	79.20	83.16
22P	83.16	87.12
23P	87.12	91.08
24P	91.08	95.04

Unit: mm

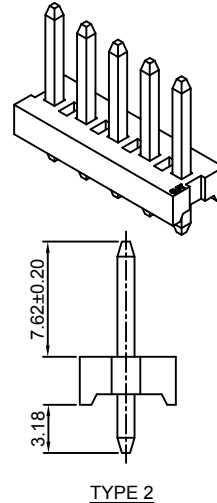
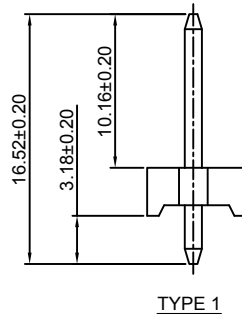
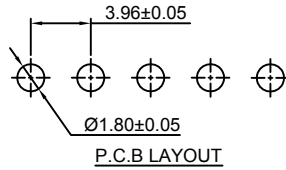
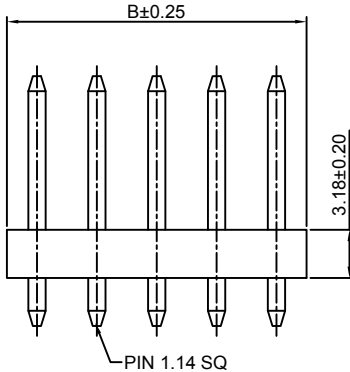
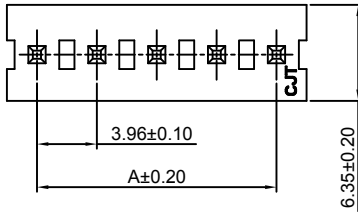

D3961WVA-XP-H

3.96mm pitch 180° Wafer

Reference Informations:

- *Material: Pin: Brass/Tin over Nickel
Insulator: Nylon 66, UL94V-0
- *Mates with CJT D3961HD, HF-XP series Housing
- *Color: Natural

Ordering Information:
 $\frac{D3961WVA-XP-H}{1} - \frac{*}{2} - \frac{***}{3} - \frac{***}{4}$

1. Part No.
2. Type:
(Blank): TYPE 1
L: TYPE 2
3. Material:
(blank): Nylon 66, UL94V-0
GWT: Nylon 66, UL94V-0, GWT 750°C
4. Finish:
(blank): Tin over Nickel
G: Gold-flash
G30: 30µin (0.76µm) MIN. Select Gold (Mating Area)
100µin (2.54µm) MIN. Select Tin

Ordering Information & Dimensions:

PART NO.	Dimensions	
	A	B
2P	3.96	7.92
3P	7.92	11.88
4P	11.88	15.84
5P	15.84	19.80
6P	19.80	23.76
7P	23.76	27.72
8P	27.72	31.68
9P	31.68	35.64
10P	35.64	39.60
11P	39.60	43.56
12P	43.56	47.52
13P	47.52	51.48
14P	51.48	55.44
15P	55.44	59.40
16P	59.40	63.36
17P	63.36	67.32
18P	67.32	71.28
19P	71.28	75.24
20P	75.24	79.20
21P	79.20	83.16
22P	83.16	87.12
23P	87.12	91.08
24P	91.08	95.04

Unit: mm

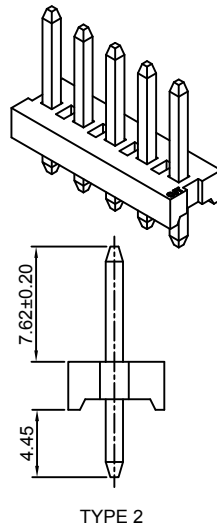
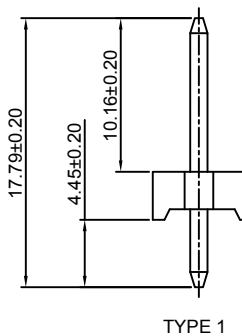
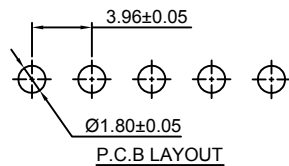
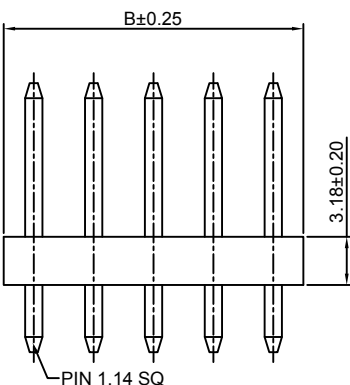
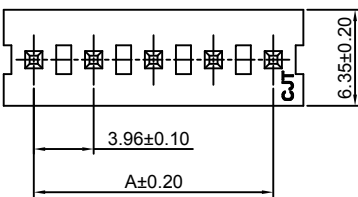

D3961WV-XP-A

3.96mm pitch 180° Wafer

Reference Informations:

- *Material:Pin:Brass/Tin over Nickel
Insulator:Nylon 66,UL94V-0
- *Mates with CJT D3961H,HA,HB,HC,HE,HG,HH,HI,HJ,HK-XP series Housing
- *Color:Natural

Ordering Information:

D3961WV-XP-A - * - *** - ***
1 2 3 4

- 1.Part No.
- 2.Type:
(Blank):TYPE 1
L:TYPE 2
- 3.Material:
(blank):Nylon 66,UL94V-0
GWT:Nylon 66,UL94V-0,GWT 750°C
- 4.Finish:
(blank):Tin over Nickel
G:Gold-flash
G30:30µin (0.76µm) MIN.Select Gold(Mating Area)
100µin (2.54µm) MIN.Select Tin

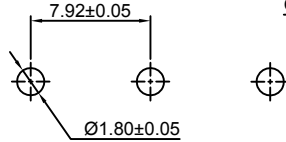
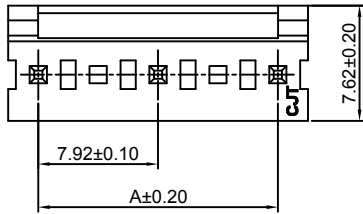
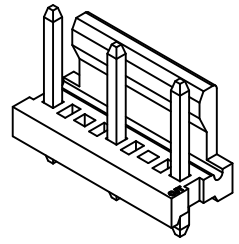

P.C.B LAYOUT

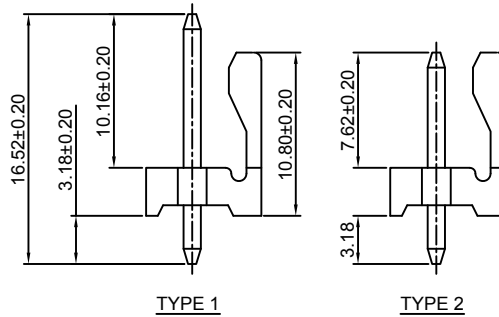
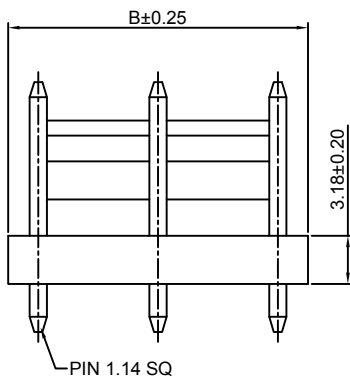

Ordering Information & Dimensions:

PART NO.	Dimensions	
	A	B
3P	7.92	11.88
5P	15.84	19.80
7P	23.76	27.72
9P	31.68	35.64
11P	39.60	43.56
13P	47.52	51.48
15P	55.44	59.40
17P	63.36	67.32
19P	71.28	75.24
21P	79.20	83.16
23P	87.12	91.08

Unit: mm

D3961WV-XP-H-A

3.96mm pitch 180° Wafer

Reference Informations:

- *Material:Pin:Brass/Tin over Nickel
Insulator:Nylon 66,UL94V-0
- *Mates with CJT D3961H,HA,HB,HC,HE,HG,HH,HI,HJ,HK-XP series Housing
- *Color:Natural

Ordering Information:

D3961WV-XP-H-A - * - *** - ***
1 2 3 4

- 1.Part No.
- 2.Type:
(Blank):TYPE 1
L:TYPE 2
- 3.Material:
(blank):Nylon 66,UL94V-0
GWT:Nylon 66,UL94V-0,GWT 750°C
- 4.Finish:
(blank):Tin over Nickel
G:Gold-flash
G30:30µin (0.76µm) MIN.Select Gold(Mating Area)
100µin (2.54µm) MIN.Select Tin

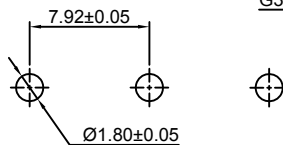
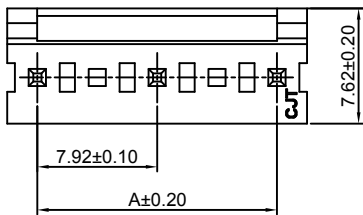
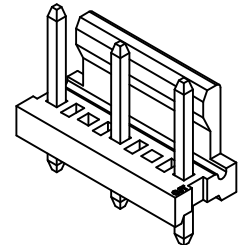

P.C.B LAYOUT

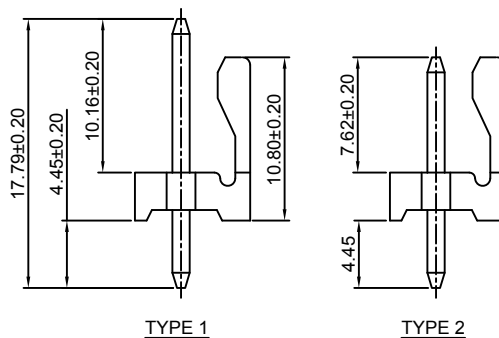
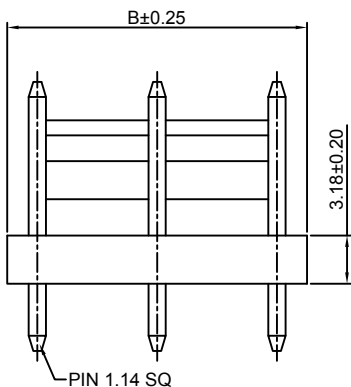

Ordering Information & Dimensions:

PART NO.	Dimensions	
	A	B
3P	7.92	11.88
5P	15.84	19.80
7P	23.76	27.72
9P	31.68	35.64
11P	39.60	43.56
13P	47.52	51.48
15P	55.44	59.40
17P	63.36	67.32
19P	71.28	75.24
21P	79.20	83.16
23P	87.12	91.08

Unit: mm

D3961WVA-XP-A

3.96mm pitch 180° Wafer

Reference Informations:

- *Material: Pin: Brass/Tin over Nickel
Insulator: Nylon 66, UL94V-0
- *Mates with CJT D3961HD, HF-XP series Housing
- *Color: Natural

Ordering Information:

D3961WVA-XP-A - * - *** - **
1 2 3 4

1. Part No.
2. Type:
(blank): TYPE 1
L: TYPE 2
3. Material:
(blank): Nylon 66, UL94V-0
GWT: Nylon 66, UL94V-0, GWT 750°C
4. Finish:
(blank): Tin over Nickel
G: Gold-flash
G30: 30µin (0.76µm) MIN. Select Gold (Mating Area)
100µin (2.54µm) MIN. Select Tin

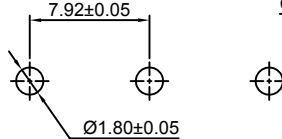
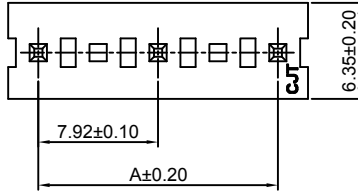
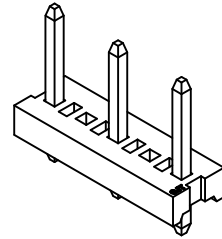

P.C.B LAYOUT

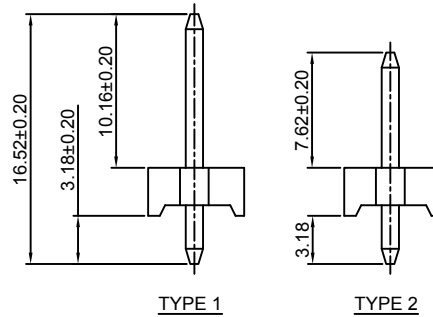
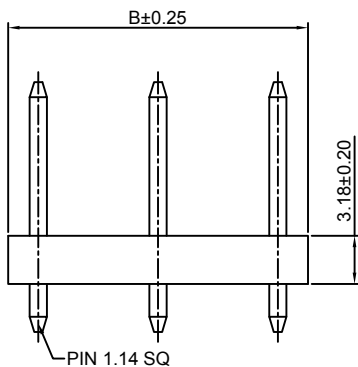

TYPE 1

TYPE 2

Ordering Information & Dimensions:

PART NO.	Dimensions	
	A	B
3P	7.92	11.88
5P	15.84	19.80
7P	23.76	27.72
9P	31.68	35.64
11P	39.60	43.56
13P	47.52	51.48
15P	55.44	59.40
17P	63.36	67.32
19P	71.28	75.24
21P	79.20	83.16
23P	87.12	91.08

Unit: mm

D3961WVA-XP-H-A

3.96mm pitch 180° Wafer

Reference Informations:

- *Material: Pin: Brass/Tin over Nickel
Insulator: Nylon 66, UL94V-0
- *Mates with CJT D3961HD, HF-XP series Housing
- *Color: Natural

Ordering Information:

D3961WVA-XP-H-A - * - *** - ***
1 2 3 4

1. Part No.
2. Type:
(blank): TYPE 1
L: TYPE 2
3. Material:
(blank): Nylon 66, UL94V-0
GWT: Nylon 66, UL94V-0, GWT 750°C
4. Finish:
(blank): Tin over Nickel
G: Gold-flash
G30: 30µin (0.76µm) MIN. Select Gold (Mating Area)
100µin (2.54µm) MIN. Select Tin

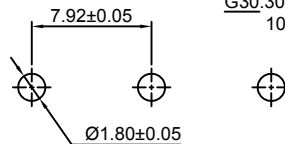
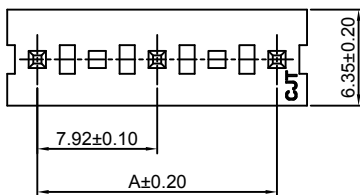
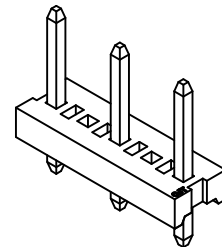

P.C.B LAYOUT

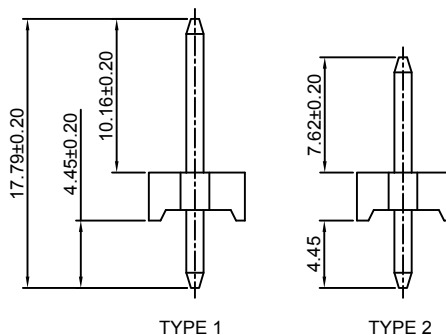
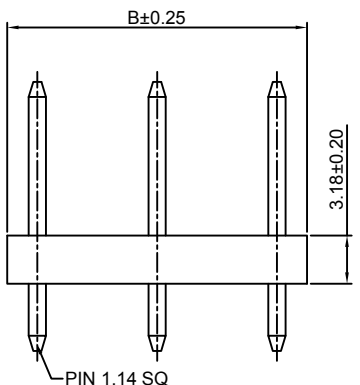

TYPE 1

TYPE 2

Ordering Information & Dimensions:

PART NO.	Dimensions	
	A	B
3P	7.92	11.88
5P	15.84	19.80
7P	23.76	27.72
9P	31.68	35.64
11P	39.60	43.56
13P	47.52	51.48
15P	55.44	59.40
17P	63.36	67.32
19P	71.28	75.24
21P	79.20	83.16
23P	87.12	91.08

Unit: mm

D3961WR-XP

3.96mm pitch 90° Wafer

Reference Informations:

- *Material: Pin: Brass/Tin over Nickel
Insulator: Nylon 66, UL94V-0
- *Mates with CJT D3961H, HA, HB, HC, HE, HG, HH, HI, HJ, HK-XP series Housing
- *Color: Natural

Ordering Information:

D3961WR-XP - * - *** - ***
1 2 3 4

1. Part No.
2. Type:
(Blank): TYPE 1
H: TYPE 2
3. Material:
(blank): Nylon 66, UL94V-0
GWT: Nylon 66, UL94V-0, GWT 750°C
4. Finish:
(blank): Tin over Nickel
G: Gold-flash
G30: 30µin (0.76µm) MIN. Select Gold (Mating Area)
100µin (2.54µm) MIN. Select Tin

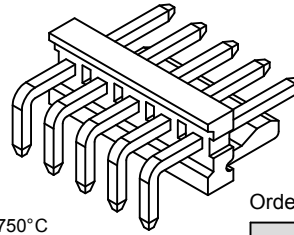

Ordering Information & Dimensions:

PART NO.	Dimensions	
	A	B
2P	3.96	7.92
3P	7.92	11.88
4P	11.88	15.84
5P	15.84	19.80
6P	19.80	23.76
7P	23.76	27.72
8P	27.72	31.68
9P	31.68	35.64
10P	35.64	39.60
11P	39.60	43.56
12P	43.56	47.52
13P	47.52	51.48
14P	51.48	55.44
15P	55.44	59.40
16P	59.40	63.36
17P	63.36	67.32
18P	67.32	71.28
19P	71.28	75.24
20P	75.24	79.20
21P	79.20	83.16
22P	83.16	87.12
23P	87.12	91.08
24P	91.08	95.04

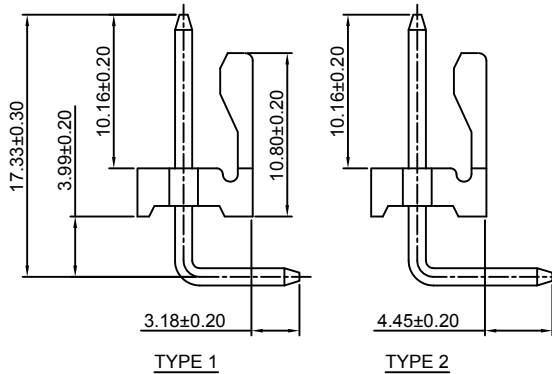
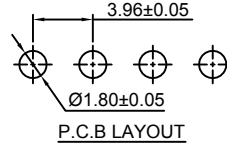
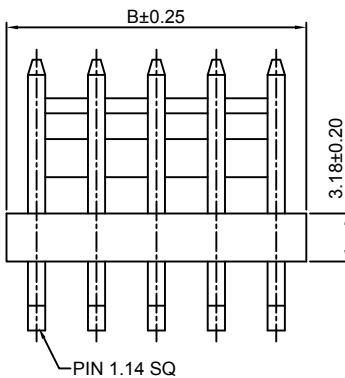
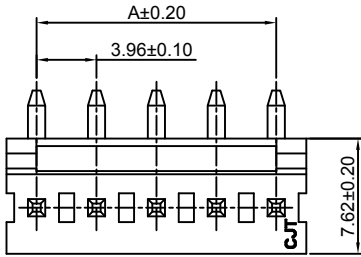

Unit: mm

D3961WR-XP-2

3.96mm pitch 90° Wafer

Reference Informations:

- *Material: Pin: Brass/Tin over Nickel
Insulator: Nylon 66, UL94V-0
- *Mates with CJT D3961H, HA, HB, HC, HE, HG, HH, HI, HJ, HK-XP series Housing
- *Color: Natural

Ordering Information:

D3961WR-XP-2 - * - *** - ***
1 2 3 4

1. Part No.
2. Type:
(Blank): TYPE 1
H: TYPE 2
3. Material:
(blank): Nylon 66, UL94V-0
GWT: Nylon 66, UL94V-0, GWT 750°C
4. Finish:
(blank): Tin over Nickel
G: Gold-flash
G30: 30µin (0.76µm) MIN. Select Gold (Mating Area)
100µin (2.54µm) MIN. Select Tin

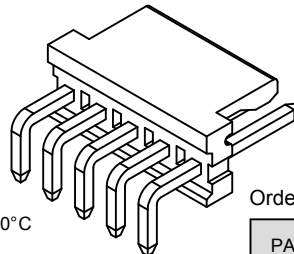

Ordering Information & Dimensions:

PART NO.	Dimensions	
	A	B
2P	3.96	7.92
3P	7.92	11.88
4P	11.88	15.84
5P	15.84	19.80
6P	19.80	23.76
7P	23.76	27.72
8P	27.72	31.68
9P	31.68	35.64
10P	35.64	39.60
11P	39.60	43.56
12P	43.56	47.52
13P	47.52	51.48
14P	51.48	55.44
15P	55.44	59.40
16P	59.40	63.36
17P	63.36	67.32
18P	67.32	71.28
19P	71.28	75.24
20P	75.24	79.20
21P	79.20	83.16
22P	83.16	87.12
23P	87.12	91.08
24P	91.08	95.04

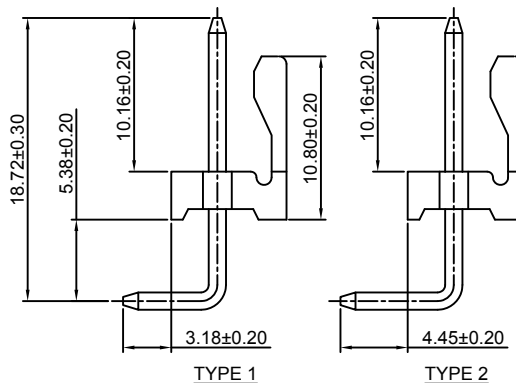
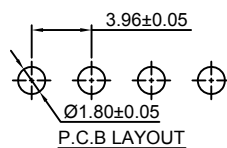
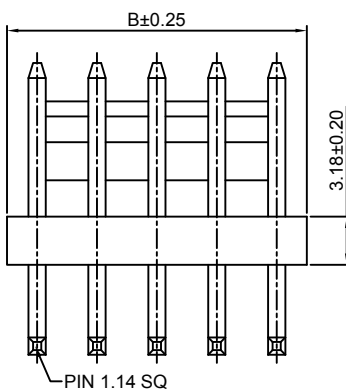
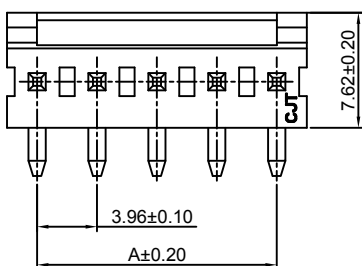

Unit: mm

D3961WRA-XP

3.96mm pitch 90° Wafer

Reference Informations:

- *Material: Pin: Brass/Tin over Nickel
Insulator: Nylon 66, UL94V-0
- *Mates with CJT D3961HD, HF-XP series Housing
- *Color: Natural

Ordering Information:
D3961WRA-XP - * - *** - ***
1 2 3 4

1. Part No.
2. Type:
(Blank): TYPE 1
H: TYPE 2
3. Material:
(blank): Nylon 66, UL94V-0
GWT: Nylon 66, UL94V-0, GWT 750°C
4. Finish:
(blank): Tin over Nickel
G: Gold-flash
G30: 30µin (0.76µm) MIN. Select Gold (Mating Area)
100µin (2.54µm) MIN. Select Tin

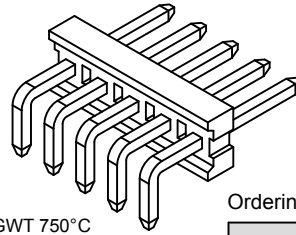

Ordering Information & Dimensions:

PART NO.	Dimensions	
	A	B
2P	3.96	7.92
3P	7.92	11.88
4P	11.88	15.84
5P	15.84	19.80
6P	19.80	23.76
7P	23.76	27.72
8P	27.72	31.68
9P	31.68	35.64
10P	35.64	39.60
11P	39.60	43.56
12P	43.56	47.52
13P	47.52	51.48
14P	51.48	55.44
15P	55.44	59.40
16P	59.40	63.36
17P	63.36	67.32
18P	67.32	71.28
19P	71.28	75.24
20P	75.24	79.20
21P	79.20	83.16
22P	83.16	87.12
23P	87.12	91.08
24P	91.08	95.04

Unit: mm

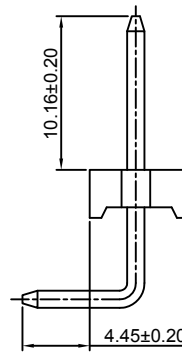
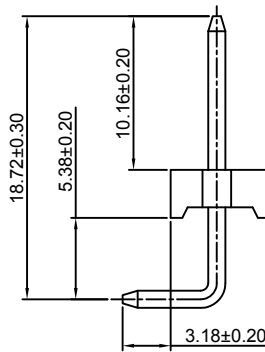
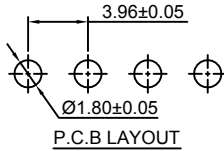
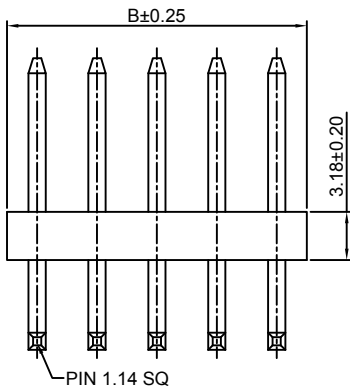
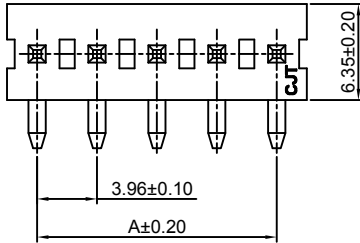

TYPE 1

TYPE 2

D3961WRA-XP-A

3.96mm pitch 90° Wafer

Reference Informations:

- *Material: Pin: Brass/Tin over Nickel
Insulator: Nylon 66, UL94V-0
- *Mates with CJT D3961HD, HF-XP series Housing
- *Color: Natural

Ordering Information:
D3961WRA-XP-A - * - *** - ***
1 2 3 4

1. Part No.
2. Type:
(Blank): TYPE 1
H: TYPE 2
3. Material:
(blank): Nylon 66, UL94V-0
GWT: Nylon 66, UL94V-0, GWT 750°C
4. Finish:
(blank): Tin over Nickel
G: Gold-flash
G30: 30µin (0.76µm) MIN. Select Gold (Mating Area)
100µin (2.54µm) MIN. Select Tin

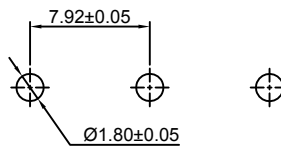
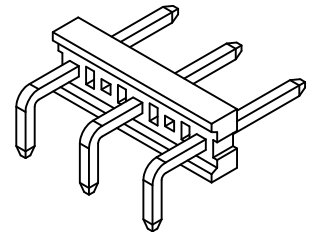

P.C.B LAYOUT

Ordering Information & Dimensions:

PART NO.	Dimensions	
	A	B
3P	7.92	11.88
5P	15.84	19.80
7P	23.76	27.72
9P	31.68	35.64
11P	39.60	43.56
13P	47.52	51.48
15P	55.44	59.40
17P	63.36	67.32
19P	71.28	75.24
21P	79.20	83.16
23P	87.12	91.08

Unit: mm

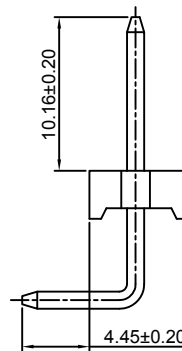
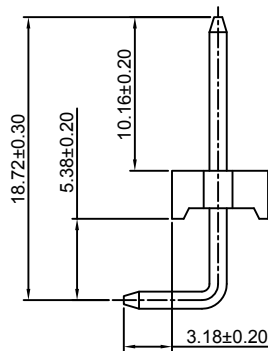
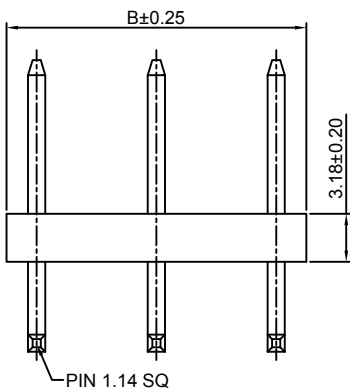
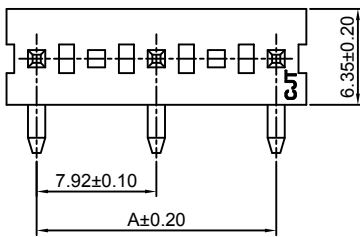

TYPE 1

TYPE 2

D3961WR-XP-A

3.96mm pitch 90° Wafer

Reference Informations:

- *Material: Pin: Brass/Tin over Nickel
Insulator: Nylon 66, UL94V-0
- *Mates with CJT D3961H, HA, HB, HC, HE, HG, HH, HI, HJ, HK-XP series Housing
- *Color: Natural

Ordering Information:

D3961WR-XP-A - * - *** - ***
1 2 3 4

1. Part No.
2. Type:
(Blank): TYPE 1
H: TYPE 2
3. Material:
(blank): Nylon 66, UL94V-0
GWT: Nylon 66, UL94V-0, GWT 750°C
4. Finish:
(blank): Tin over Nickel
G: Gold-flash
G30: 30µin (0.76µm) MIN. Select Gold (Mating Area)
100µin (2.54µm) MIN. Select Tin

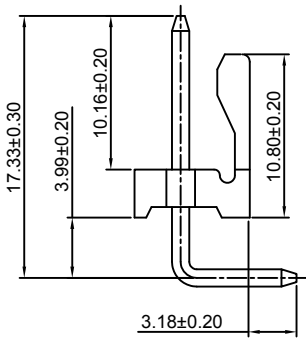
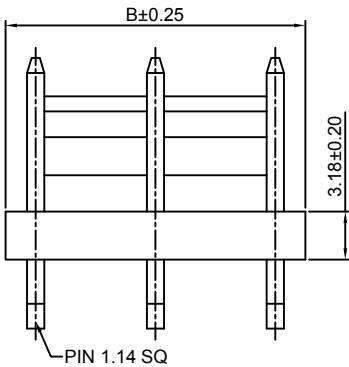
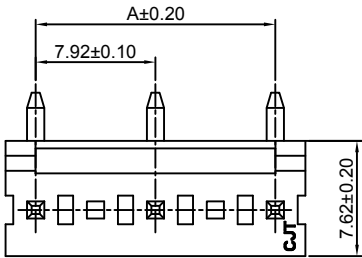

TYPE 1

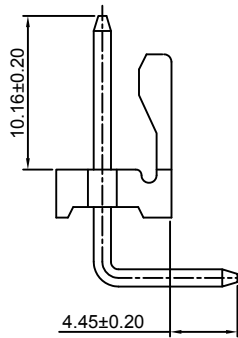

TYPE 2

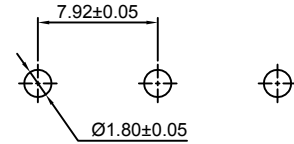
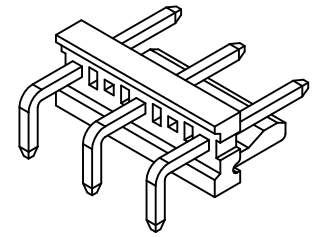

P.C.B LAYOUT

Ordering Information & Dimensions:

PART NO.	Dimensions	
	A	B
3P	7.92	11.88
5P	15.84	19.80
7P	23.76	27.72
9P	31.68	35.64
11P	39.60	43.56
13P	47.52	51.48
15P	55.44	59.40
17P	63.36	67.32
19P	71.28	75.24
21P	79.20	83.16
23P	87.12	91.08

Unit: mm

D3961WR-XP-2-A

3.96mm pitch 90° Wafer

Reference Informations:

- *Material: Pin: Brass/Tin over Nickel
Insulator: Nylon 66, UL94V-0
- *Mates with CJT D3961H, HA, HB, HC, HE, HG, HH, HI, HJ, HK-XP series Housing
- *Color: Natural

Ordering Information:

D3961WR-XP-2-A - * - *** - ***
1 2 3 4

1. Part No.
2. Type:
(Blank): TYPE 1
H: TYPE 2
3. Material:
(blank): Nylon 66, UL94V-0
GWT: Nylon 66, UL94V-0, GWT 750°C
4. Finish:
(blank): Tin over Nickel
G: Gold-flash
G30: 30µin (0.76µm) MIN. Select Gold (Mating Area)
100µin (2.54µm) MIN. Select Tin

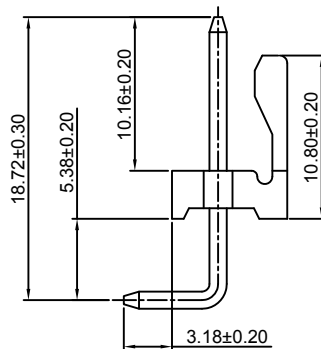
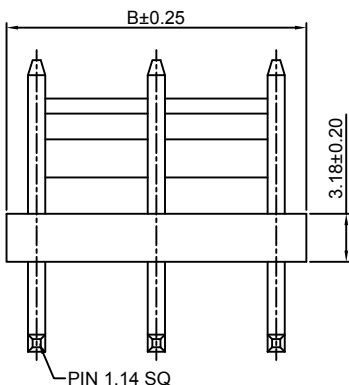
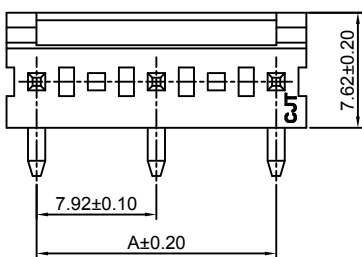

TYPE 1

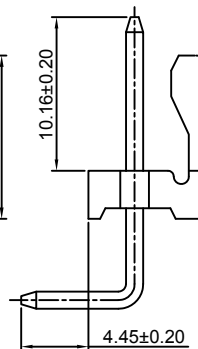

TYPE 2

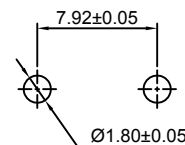
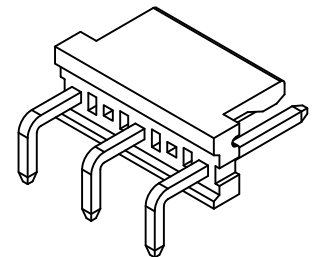

P.C.B LAYOUT

Ordering Information & Dimensions:

PART NO.	Dimensions	
	A	B
3P	7.92	11.88
5P	15.84	19.80
7P	23.76	27.72
9P	31.68	35.64
11P	39.60	43.56
13P	47.52	51.48
15P	55.44	59.40
17P	63.36	67.32
19P	71.28	75.24
21P	79.20	83.16
23P	87.12	91.08

Unit: mm

D3961WRB-XP

3.96mm pitch 90° Wafer

Reference Informations:

- *Material: Pin: Brass/Tin over Nickel
Insulator: Nylon 66, UL94V-0
- *Mates with CJT D3961HD, HF-XP series Housing
- *Color: Natural

Ordering Information:

D3961WRB-XP - * - *** - ***
1 2 3 4

1. Part No.
2. Type:
(Blank): TYPE 1
H: TYPE 2
3. Material:
(Blank): Nylon 66, UL94V-0
GWT: Nylon 66, UL94V-0, GWT 750°C
4. Finish:
(blank): Tin over Nickel
G: Gold-flash
G30: 30µin (0.76µm) MIN. Select Gold (Mating Area)
100µin (2.54µm) MIN. Select Tin

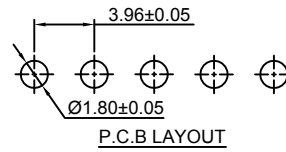

Ordering Information & Dimensions:

PART NO.	Dimensions	
	A	B
2P	3.96	7.92
3P	7.92	11.88
4P	11.88	15.84
5P	15.84	19.80
6P	19.80	23.76
7P	23.76	27.72
8P	27.72	31.68
9P	31.68	35.64
10P	35.64	39.60
11P	39.60	43.56
12P	43.56	47.52
13P	47.52	51.48
14P	51.48	55.44
15P	55.44	59.40
16P	59.40	63.36
17P	63.36	67.32
18P	67.32	71.28
19P	71.28	75.24
20P	75.24	79.20
21P	79.20	83.16
22P	83.16	87.12
23P	87.12	91.08
24P	91.08	95.04

Unit: mm

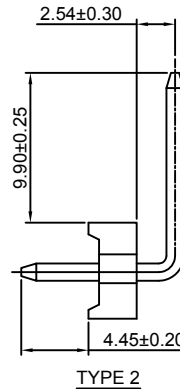
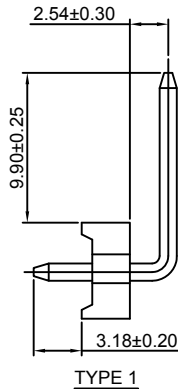
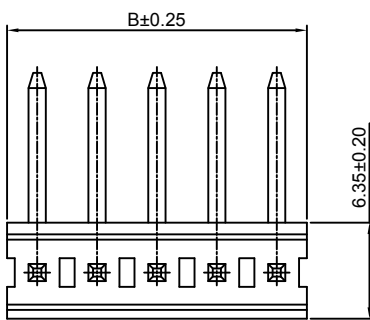
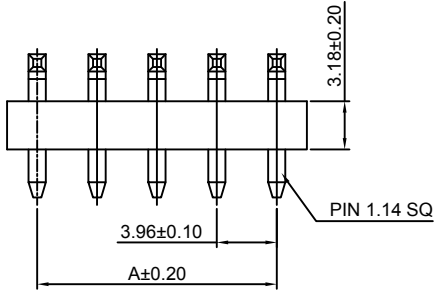

D3961WRB-XP-A

3.96mm pitch 90° Wafer

Reference Informations:

- *Material: Pin: Brass/Tin over Nickel
Insulator: Nylon 66, UL94V-0
- *Mates with CJT D3961HD, HF-XP series Housing
- *Color: Natural

Ordering Information:

D3961WRB-XP-A - * - *** - ***
1 2 3 4

1. Part No.
2. Type:
(Blank): TYPE 1
H: TYPE 2
3. Material:
(Blank): Nylon 66, UL94V-0
GWT: Nylon 66, UL94V-0, GWT 750°C
4. Finish:
(blank): Tin over Nickel
G: Gold-flash
G30: 30µin (0.76µm) MIN. Select Gold (Mating Area)
100µin (2.54µm) MIN. Select Tin

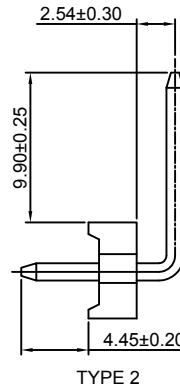
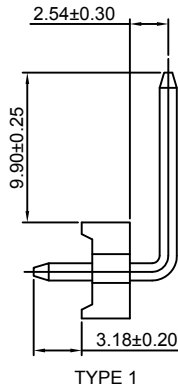
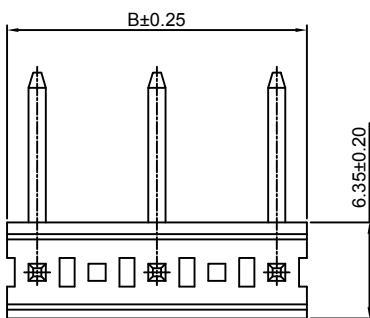
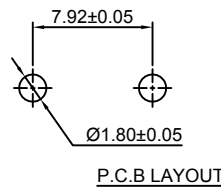
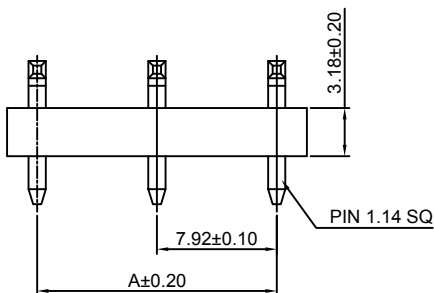

Ordering Information & Dimensions:

PART NO.	Dimensions	
	A	B
3P	7.92	11.88
5P	15.84	19.80
7P	23.76	27.72
9P	31.68	35.64
11P	39.60	43.56
13P	47.52	51.48
15P	55.44	59.40
17P	63.36	67.32
19P	71.28	75.24
21P	79.20	83.16
23P	87.12	91.08

Unit: mm

D3961WVD-XP

3.96mm pitch 180° Wafer

Reference Informations:

- *Material:Pin:Brass/Tin over Nickel
Insulator:Nylon 46,UL94V-0
- *Mates with CJT D3961H,HA,HB,HC,HE,HG,HH,HI,HJ,HK-XP series Housing
- *Color:Black

Ordering Information:
D3961WVD-XP - *** - ***
1 2 3

- 1.Part No.
- 2.Material:
(blank):Nylon 46,UL94V-0
GWT:Nylon 46,UL94V-0,GWT 750°C
- 3.Finish:
(blank):Tin over Nickel
G:Gold-flash
G15:15µin (0.38µm) MIN.Select Gold(Mating Area)
100µin (2.54µm) MIN.Select Tin
G30:30µin (0.76µm) MIN.Select Gold(Mating Area)
100µin (2.54µm) MIN.Select Tin

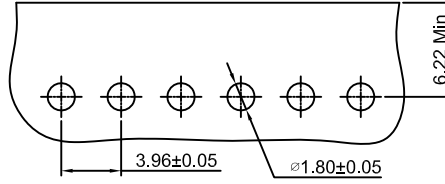
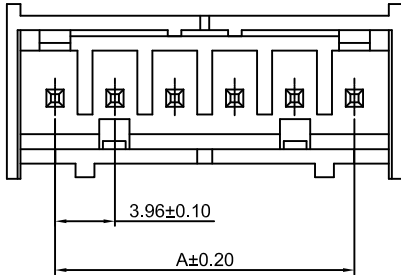
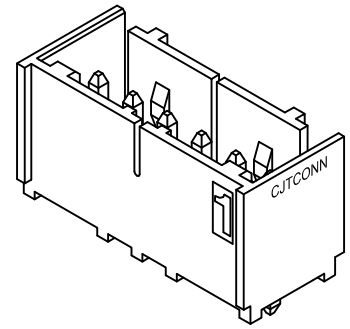

P.C.B LAYOUT

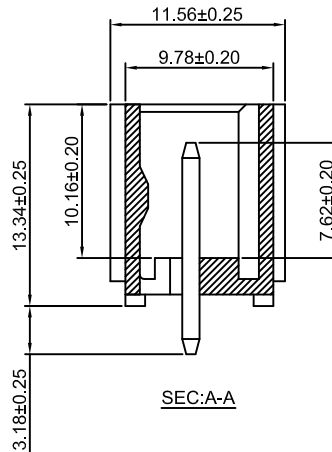
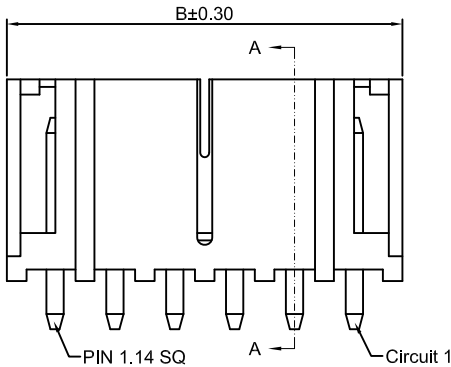

SEC:A-A

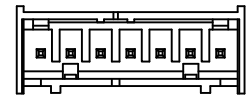
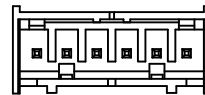
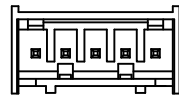
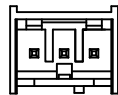

2P

3P

4P~5P

6P

7P

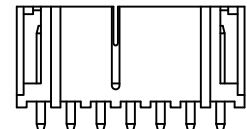
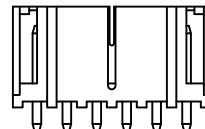
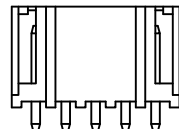
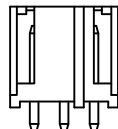
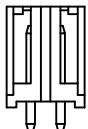

8P

9P~12P

Ordering Information & Dimensions:

PART NO.	Dimensions	
	A	B
2P	3.96	10.31
3P	7.92	14.27
4P	11.88	18.23
5P	15.84	22.19
6P	19.80	26.15
7P	23.76	30.11
8P	27.72	34.07
9P	31.68	38.03
10P	35.64	41.99
11P	39.60	45.95
12P	43.56	49.91

Unit: mm

D3961WVD-F-XP

3.96mm pitch 180° Wafer

Reference Informations:

- *Material:Pin:Brass/Tin over Nickel
Insulator:Nylon 46,UL94V-0
- *Mates with CJT D3961H,HA,HB,HC,HE,HG,HH,HI,HJ,HK-XP series Housing
- *Color:Black

Ordering Information:

- D3961WVD-F-XP - *** - ***
1 2 3
- 1.Part No.
 - 2.Material:
(blank):Nylon 46,UL94V-0
GWT:Nylon 46,UL94V-0,GWT 750°C
 - 3.Finish:
(blank):Tin over Nickel
G:Gold-flash
G15:15µin (0.38µm) MIN.Select Gold(Mating Area)
100µin (2.54µm) MIN.Select Tin
G30:30µin (0.76µm) MIN.Select Gold(Mating Area)
100µin (2.54µm) MIN.Select Tin

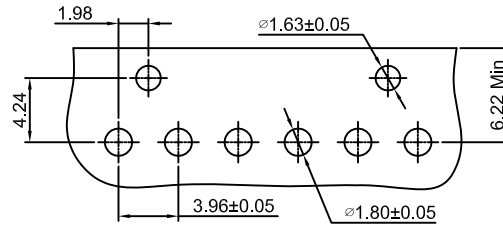
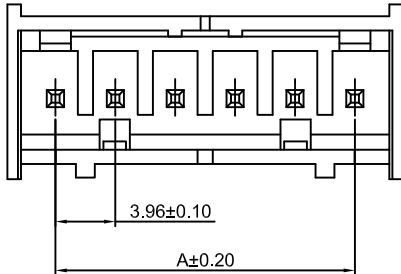
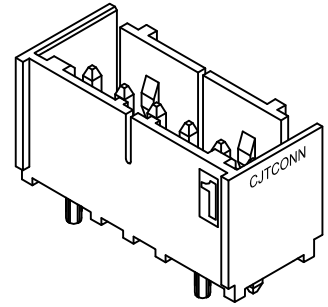

P.C.B LAYOUT

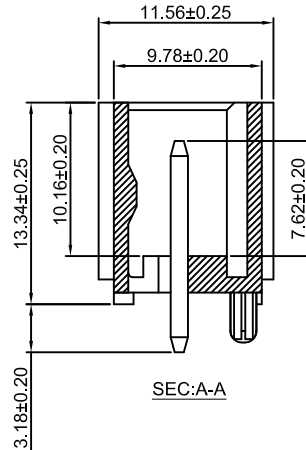
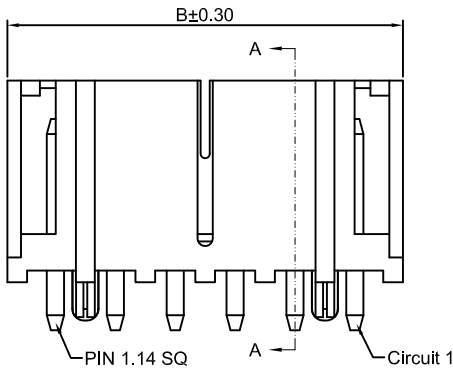

SEC:A-A

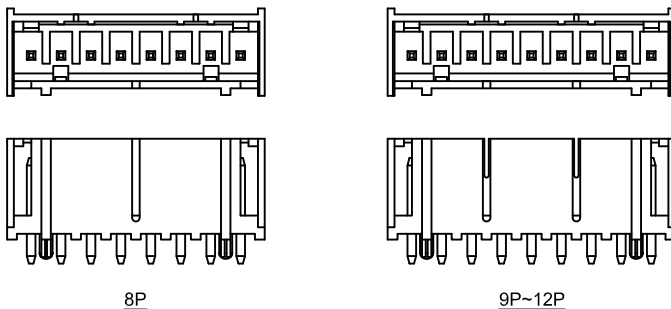
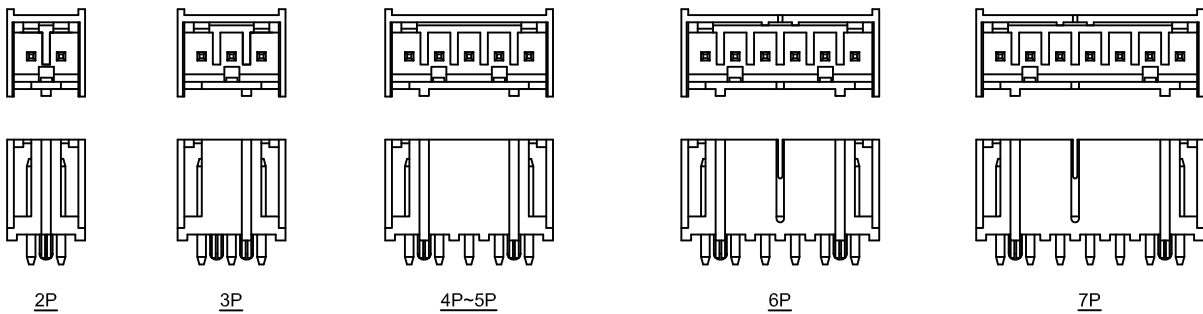

Ordering Information & Dimensions:

PART NO.	Dimensions	
	A	B
2P	3.96	10.31
3P	7.92	14.27
4P	11.88	18.23
5P	15.84	22.19
6P	19.80	26.15
7P	23.76	30.11
8P	27.72	34.07
9P	31.68	38.03
10P	35.64	41.99
11P	39.60	45.95
12P	43.56	49.91

Unit: mm

D3961WRD-XP

3.96mm pitch 90° Wafer

Reference Informations:

- *Material:Pin:Brass/Tin over Nickel
Insulator:Nylon 46,UL94V-0
- *Mates with CJT D3961H,HA,HB,HC,HE,HG,HH,HI,HJ,HK-XP series Housing
- *Color:Black

Ordering Information:
D3961WRD-XP - *** - ***
1 2 3

- 1.Part No.
- 2.Material:
(blank):Nylon 46,UL94V-0
GWT:Nylon 46,UL94V-0,GWT 750°C
- 3.Finish:
(blank):Tin over Nickel
G:Gold-flash
G15:15µin (0.38µm) MIN.Select Gold(Mating Area)
100µin (2.54µm) MIN.Select Tin
G30:30µin (0.76µm) MIN.Select Gold(Mating Area)
100µin (2.54µm) MIN.Select Tin

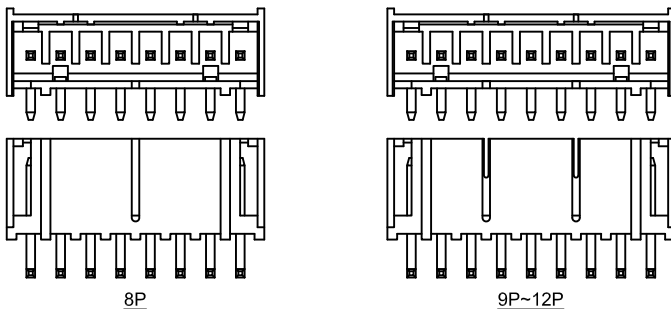
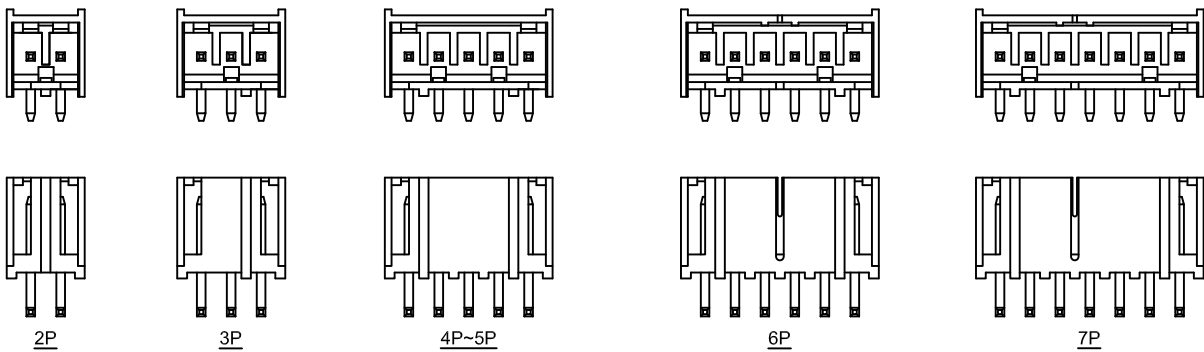
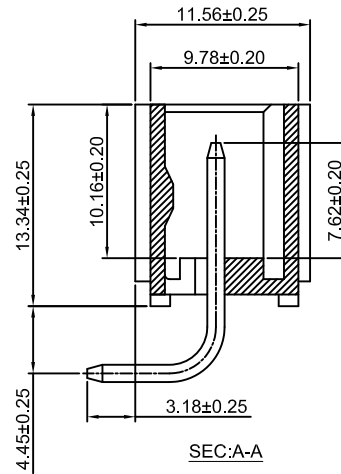
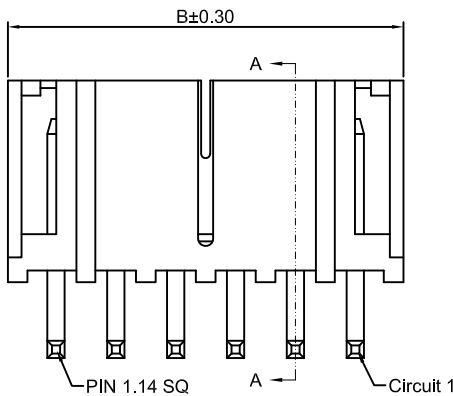
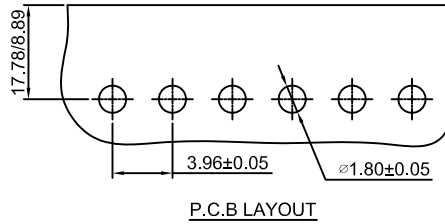
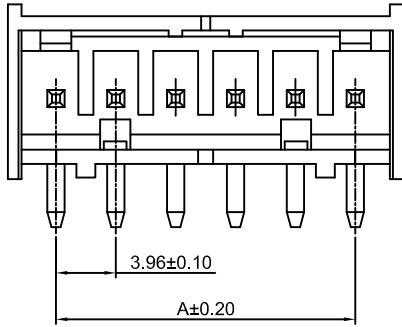
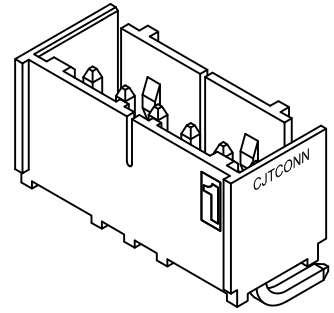

Ordering Information & Dimensions:

PART NO.	Dimensions	
	A	B
2P	3.96	10.31
3P	7.92	14.27
4P	11.88	18.23
5P	15.84	22.19
6P	19.80	26.15
7P	23.76	30.11
8P	27.72	34.07
9P	31.68	38.03
10P	35.64	41.99
11P	39.60	45.95
12P	43.56	49.91

Unit: mm

D3961WRD-XP-2

3.96mm pitch 90° Wafer

Reference Informations:

- *Material:Pin:Brass/Tin over Nickel
Insulator:Nylon 46,UL94V-0
- *Mates with CJT D3961H,HA,HB,HC,HE,HG,HH,HI,HJ,HK-XP series Housing
- *Color:Black

Ordering Information:

- D3961WRD-XP-2 - *** - ***
1 2 3
- 1.Part No.
 - 2.Material:
(blank):Nylon 46,UL94V-0
GWT:Nylon 46,UL94V-0,GWT 750° C
 - 3.Finish:
(blank):Tin over Nickel
G:Gold-flash
G15:15µin (0.38µm) MIN.Select Gold(Mating Area)
100µin (2.54µm) MIN.Select Tin
G30:30µin (0.76µm) MIN.Select Gold(Mating Area)
100µin (2.54µm) MIN.Select Tin

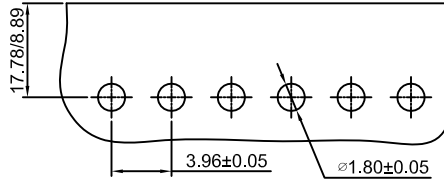
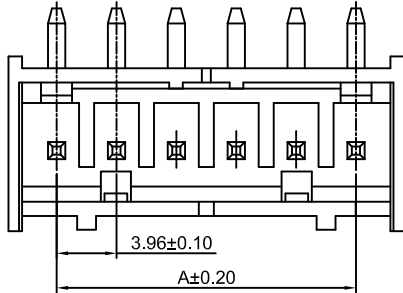
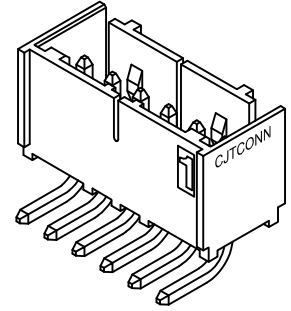

P.C.B LAYOUT

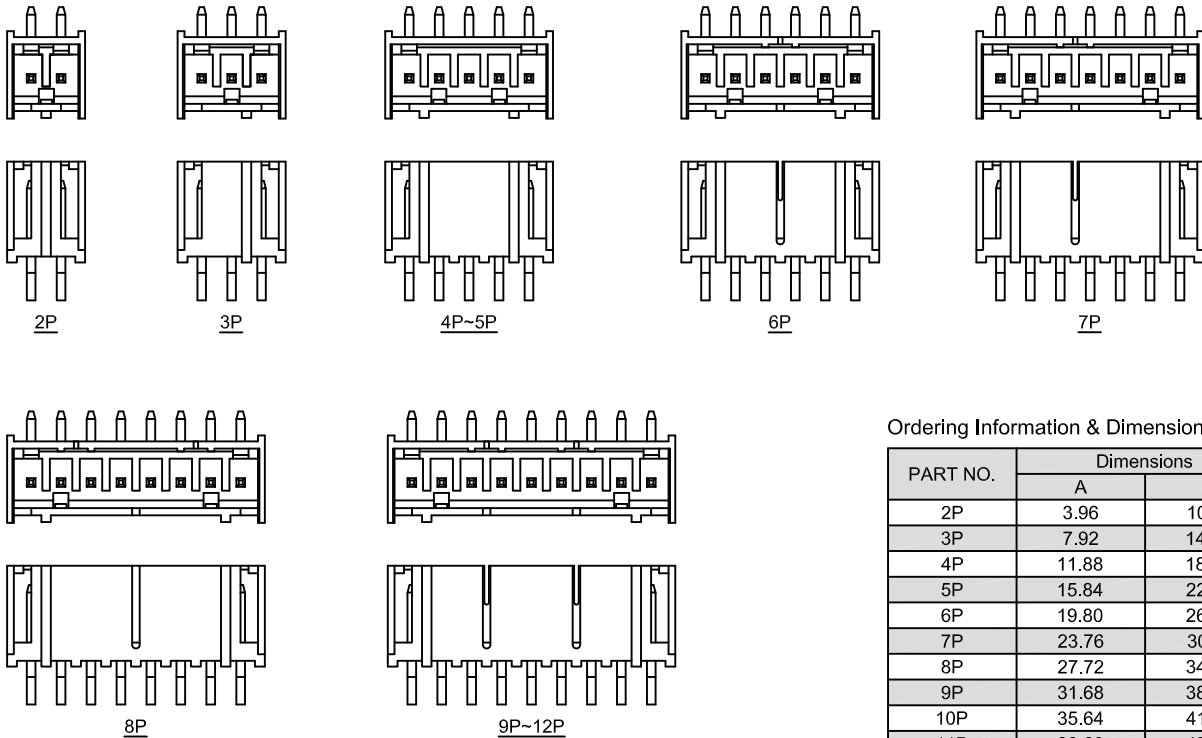
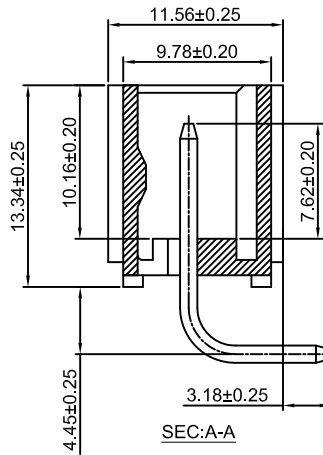
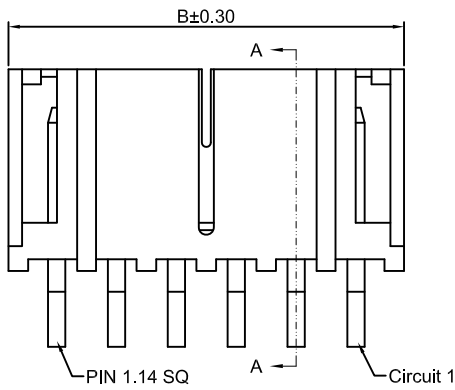

Ordering Information & Dimensions:

PART NO.	Dimensions	
	A	B
2P	3.96	10.31
3P	7.92	14.27
4P	11.88	18.23
5P	15.84	22.19
6P	19.80	26.15
7P	23.76	30.11
8P	27.72	34.07
9P	31.68	38.03
10P	35.64	41.99
11P	39.60	45.95
12P	43.56	49.91

Unit: mm