

Specifications

- Current rating:6A AC,DC
Voltage rating:300V AC,DC
Temperature range:-40°C~+105°C
Contact resistance:10mΩ Max.
Insulation resistance:1000MΩ Min.
Withstanding voltage:1500V AC/minute
Compliant with RoHS and REACH
Meet the HF/Halogen Free,GWT/Glow wire Test (IEC60335-1) request,need to customize
Contact CJT for details

Standards



Assembly layout

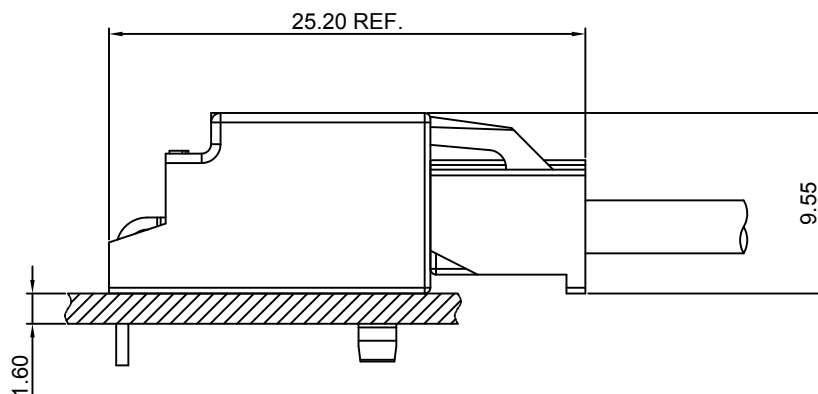

C3962-T

3.96mm pitch Crimp Terminal

Reference Informations:

*Used in CJT C3962H-XP series Housing

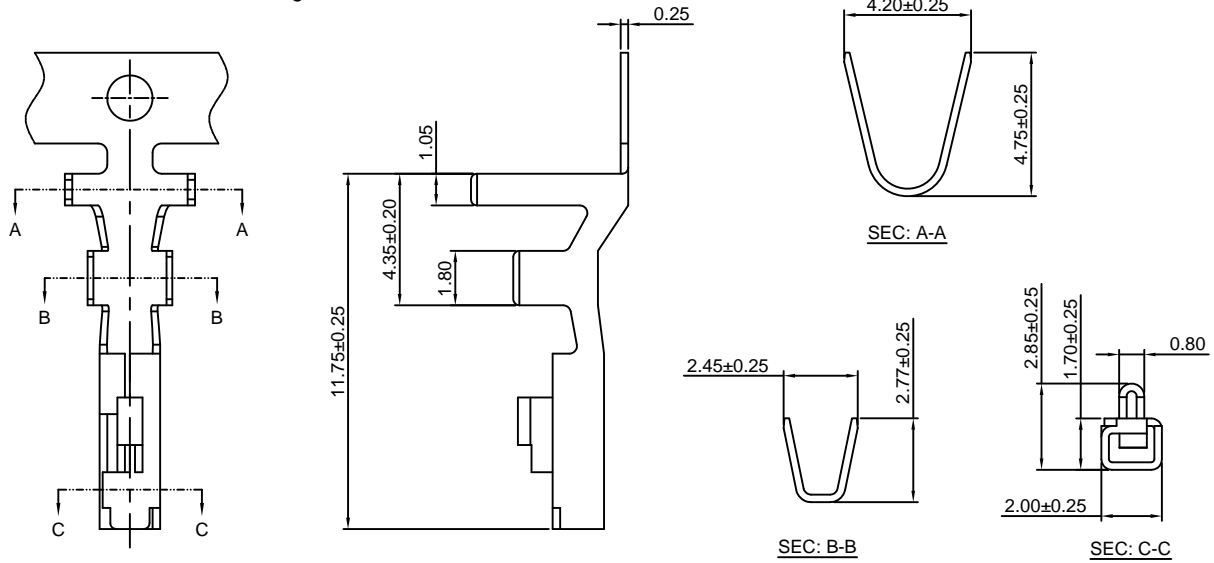

Ordering information & Specifications:

Unit:mm

Part NO.	Wire Range	Insulation O.D.	Material	Finish	Qty/reel
C3962-TB	AWG#18-#22	2.80mm(max)	Brass	Tin over Nickel	3,000 PCS
C3962-TP	AWG#18-#22	2.80mm(max)	Phosphor Bronze	Tin over Nickel	3,000 PCS
C3962-GB	AWG#18-#22	2.80mm(max)	Brass	Gold over Nickel	3,000 PCS
C3962-GP	AWG#18-#22	2.80mm(max)	Phosphor Bronze	Gold over Nickel	3,000 PCS

Optional Gold plating available but MOQ requested

C3962H-XP

3.96mm Pitch Housing

Reference Informations:

*Material:Nylon 66,UL94V-0

*Suitable CJT C3962-T series Terminal

*Mates with CJT C3962WR-F-XP series Wafer

*Color:White

Ordering Information:

C3962H-XP - *** - **
1 2 3

1.Part No.

2.Material:

(blank):Nylon 66,UL94V-0

GWT:Nylon 66,UL94V-0,GWT 750°C

3.Color:

(blank):White

BK:Black

RD:Red

BL:Blue

YL:Yellow

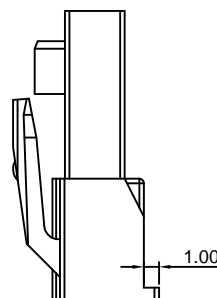
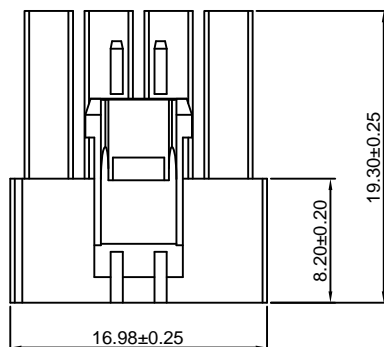
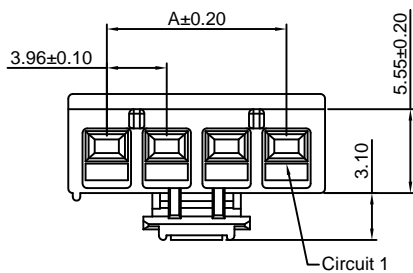
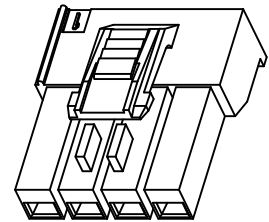

Ordering Information & Dimensions:

PART NO.	Dimensions	
	A	B
2P	3.96	9.06
3P	7.92	13.02
4P	11.88	16.98
5P	15.84	20.94
6P	19.80	24.90

Unit: mm

C3962WV-XP

3.96mm Pitch 180° Wafer

Reference Informations:

- *Material: Pin: Brass/Tin over Nickel
Insulator: Nylon 66, UL94V-0
- *Mates with CJT C3962H-XP series Housing
- *Color: white

Ordering Information:

- C3962WV-2P - *** - **
1 2 3
- Part No.
 - Material:
(blank): Nylon 66, UL94V-0
GWT: Nylon 66, UL94V-0, GWT 750°C
 - Color:
(blank): White
BK: Black
RD: Red
BL: Blue
YL: Yellow

Ordering Information:

- C3962WV-3P-A - *** - **
1 2 3
- Part No.
 - Material:
(blank): Nylon 66, UL94V-0
GWT: Nylon 66, UL94V-0, GWT 750°C
 - Color:
(blank): White
BK: Black
RD: Red
BL: Blue
YL: Yellow

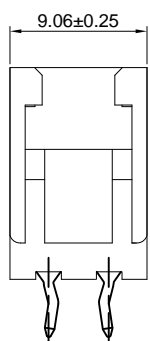
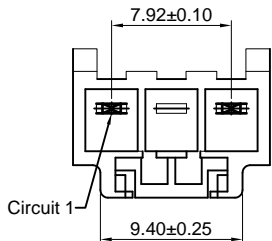
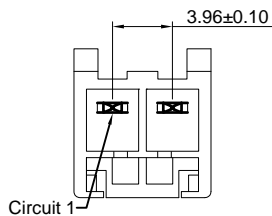

C3962WV-2P

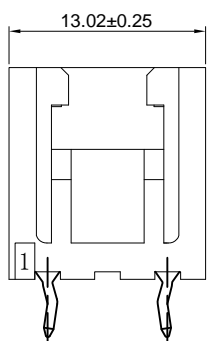

C3962WV-3P-A

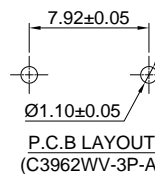
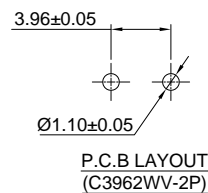
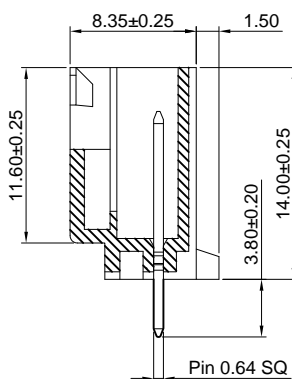

Unit: mm

C3962WVA-XP

3.96mm Pitch 180° Wafer

Reference Informations:

- *Material: Pin: Brass/Tin over Nickel
Insulator: Nylon 66, UL94V-0
- *Mates with CJT C3962H-XP series Housing
- *Color: white

Ordering Information:

- C3962WVA-XP - *** - **
1 2 3
- Part No.
 - Material:
(blank): Nylon 66, UL94V-0
GWT: Nylon 66, UL94V-0, GWT 750°C
 - Color:
(blank): White
BK: Black
RD: Red
BL: Blue
YL: Yellow

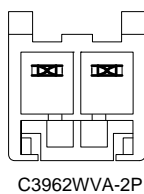
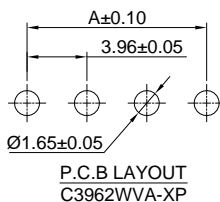
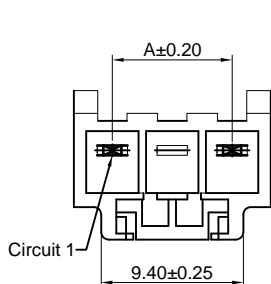
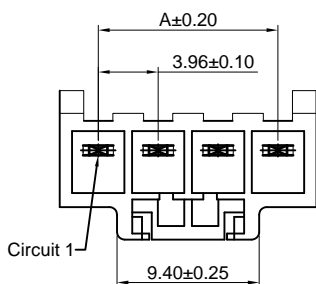

C3962WVA-2P

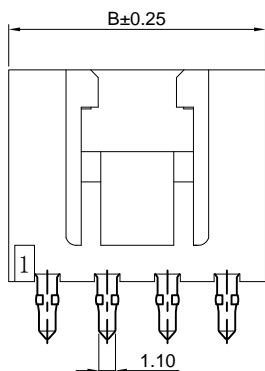

C3962WVA-XP

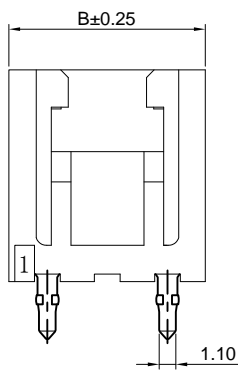

C3962WVA-3P(5P)-A

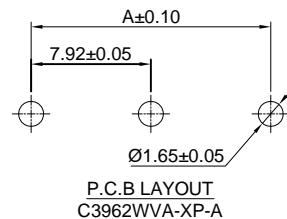
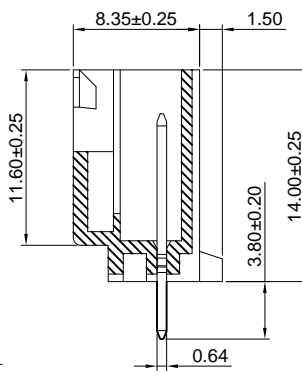

P.C.B LAYOUT
C3962WVA-XP-A

Ordering Information & Dimensions:

PART NO.	Dimensions	
	A	B
2P	3.96	9.06
3P	7.92	13.02
4P	11.88	16.98
5P	15.84	20.94
6P	19.80	24.90

Unit: mm

C3962WV-XP-2

3.96mm Pitch 180° Wafer

Reference Informations:

- *Material: Pin: Brass/Tin over Nickel
Insulator: Nylon 66, UL94V-0
- *Mates with CJT C3962H-XP series Housing
- *Color: white

Ordering Information:

- C3962WV-XP-2 - *** - **
 $\frac{1}{2} \frac{3}{3}$
- Part No.
 - Material:
(blank): Nylon 66, UL94V-0
GWT: Nylon 66, UL94V-0, GWT 750°C
 - Color:
(blank): White
BK: Black
RD: Red
BL: Blue
YL: Yellow

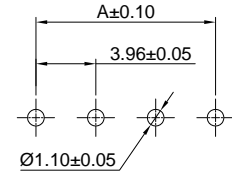
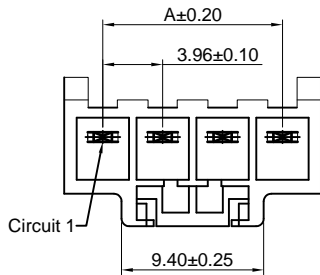

P.C.B LAYOUT
(2P-6P)

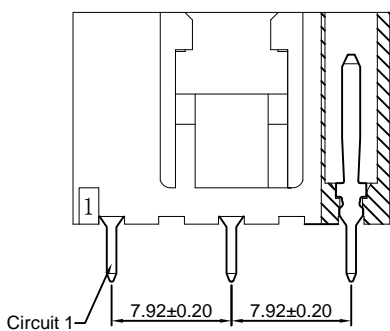
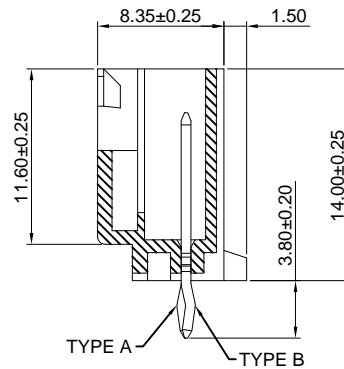
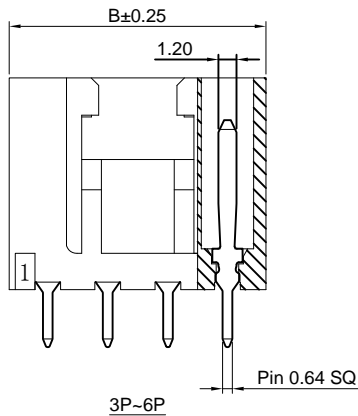

A3962WV-5P-2-A

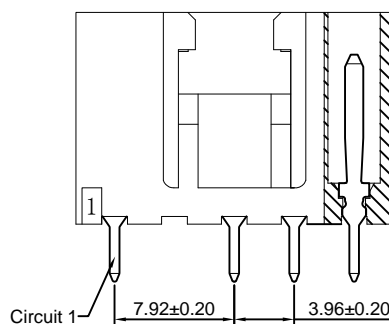

A3962WV-5P-2-N2

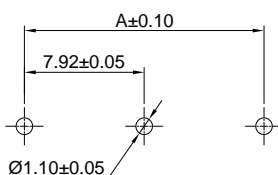

P.C.B LAYOUT
(A3962WV-5P-2-A)

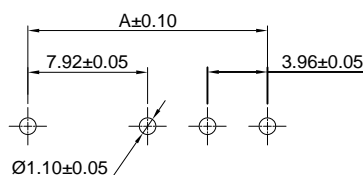

P.C.B LAYOUT
(A3962WV-5P-2-N2)

King To Be Applied As Follows

Circuits	Circuits NO.					
	1	2	3	4	5	6
A3962WV-3P-2	A	B	A			
A3962WV-4P-2	A	B	A	B		
A3962WV-5P-2	A	B	A	B	A	
A3962WV-5P-2-A	A	⊗	B	⊗	A	
A3962WV-5P-2-N2	A	⊗	B	B	A	
A3962WV-6P-2	A	B	A	B	A	B

Ordering Information & Dimensions:

PART NO.	Dimensions	
	A	B
3P	7.92	13.02
4P	11.88	16.98
5P	15.84	20.94
6P	19.80	24.90

Unit: mm

C3962WR-F-XP

3.96mm Pitch 90° Wafer

Reference Informations:

- *Material: Pin: Brass/Tin over Nickel
Insulator: Nylon 66, UL94V-0
- *Mates with CJT C3962H-XP series Housing
- *Color: white

Ordering Information:

C3962WR-F-XP - *** - **
1 2 3

- Part No.
- Material:
(blank): Nylon 66, UL94V-0
GWT: Nylon 66, UL94V-0, GWT 750°C
- Color:
(blank): White
BK: Black
RD: Red
BL: Blue
YL: Yellow

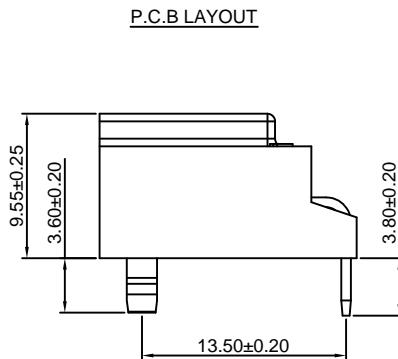
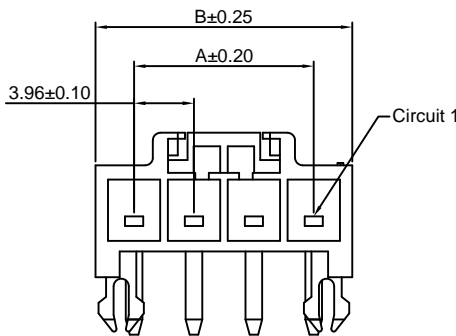
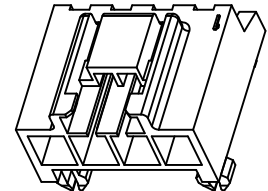
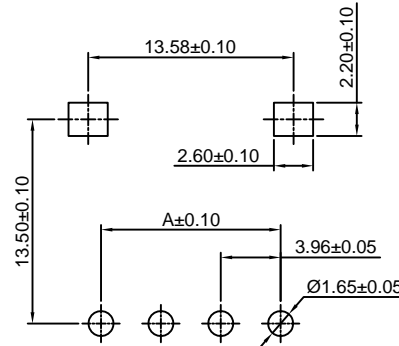
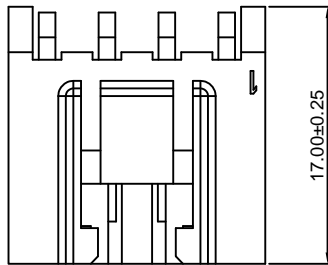

Ordering Information & Dimensions:

PART NO.	Dimensions	
	A	B
2P	3.96	9.06
3P	7.92	13.02
4P	11.88	16.98
5P	15.84	20.94
6P	19.80	24.90

Unit: mm

C3962WR-S-F-XP-A

3.96mm Pitch 90° Wafer - SMT TYPE

Reference Informations:

- *Material: Pin: Brass/Tin over Nickel
Insulator: Nylon 66, UL94V-0
- *Mates with CJT C3962H-XP series Housing
- *Color: white

Ordering Information:

C3962WR-S-F-XP-A - *** - **
1 2 3

- Part No.
- Material:
(blank): Nylon 66, UL94V-0
GWT: Nylon 66, UL94V-0, GWT 750°C
- Color:
(blank): White
BK: Black
RD: Red
BL: Blue
YL: Yellow

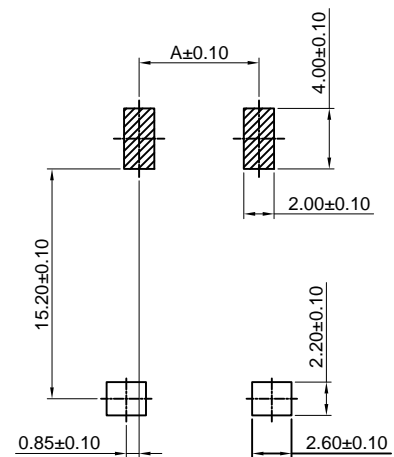
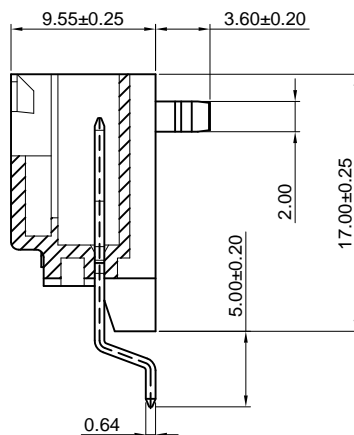
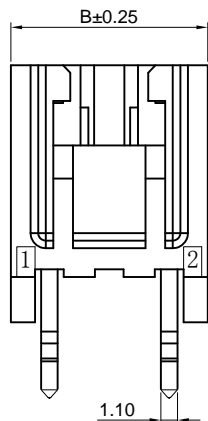
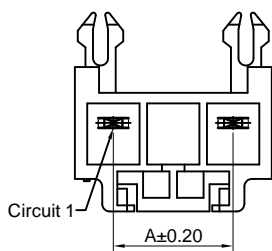

P.C.B LAYOUT

Ordering Information & Dimensions:

PART NO.	Dimensions	
	A	B
3P	7.92	13.02
5P	15.84	20.94

Unit: mm