

TYPE:

No.	Description	Material	Remarks	QTY
5	OUT SHELL	SUS304 T=0.25mm	Nickel 30u" Min Plating	1PCS
4	INT SHELL	SUS304 T=0.30mm	Nickel 30u" Min Plating	1PCS
3	Shielding Plate	SUS301 T=0.15mm	Nickel 30u" Min Plating	1PCS
2	Contact	C18400 T=0.12mm	Au 3u"Plated On Vontact Area GF Plated On Solder Area; Nickel 50u"Min Under Plating Over All.	2SET
1	Housing	PA9T UL94V-0	Black	1PCS

CJTconn CHANGJIANG CONNECTORS CO.,LTD.

Unit	Scale	Sheet	TITLE
mm	1:1	1 of 3	USB4 Type C Female 24Pin Mid-Mount, Offset Height 1.08mm, Dual- Row SMT, CH=0.5mm, L=8.12, Solder TAB=0.8mm
DRAWN	CHK'D	APPR	DRAWING NO.
Haisen Li	Diankui Wan	Jack Yin	CJ-CF324-013-24P
General Tolerances	THIRD ANGLE PROJECTION		REV
x.xx±0.25 x.xxx±0.20 x.xxx±0.15 ANGLES ±1°			A0

REV	DESCRIPTION	DATE
A0	NEW RELEASE	2020.12.15

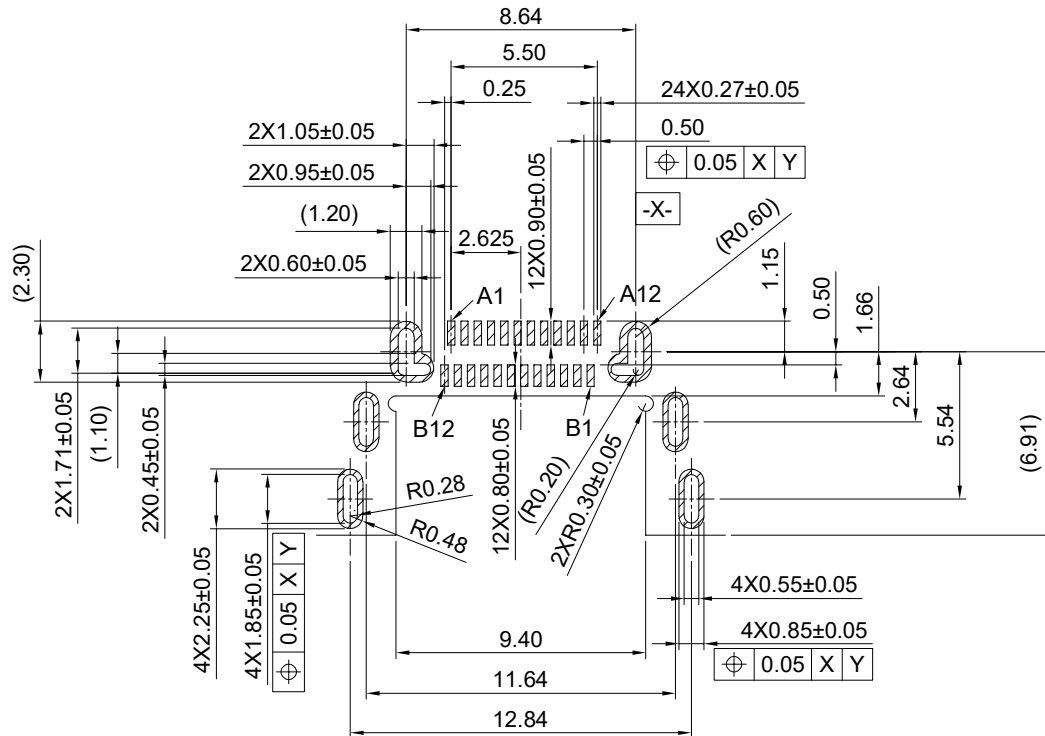

RECOMMEND P.C.B LAYOUT(TOW VIEW)
TOLERANCE FOR PCB LAYOUT IS ± 0.05
PCB THICKNESS:0.6MM

USB Type-C Pin Assignments

Pin Number	Signal Name	Pin Number	Signal Name
A1	GND	B12	GND
A2	TX1+	B11	TX1+
A3	TX1-	B10	TX1-
A4	VBUS	B9	VBUS
A5	CC1	B8	SBU2
A6	Dp1	B7	Dn2
A7	Dn1	B6	Dp2
A8	SBU1	B5	CC2
A9	VBUS	B4	VBUS
A10	RX2-	B3	RX2-
A11	RX2+	B2	RX2+
A12	GND	B1	GND

SPECIFICATIONS:

- 1.ELECTRICAL PERFORMANCE,
 - 1-1. CURRENT RATING:5 AMPS. FOR TOTAL VBUS/GND PINS;
1.25AMPS FOR CC PIN,
0.25 AMPS. FOR ALL OTHER CONTACT.
 - 1-2. VOLTAGE RATING:20 V DC/AC (RMS. MAX)
 - 1-3. CONTACT RESISTANCE: 40m Ω MAX INITIAL.
50m Ω MAX AFTER TEST
 - 1-4.DIELECTRIC WITHSTANDING VOLTAGE: 100V AC
 - 1-5.INSULATION RESISTANCE:100M Ω MIN
- 2.MECHANICAL PERFORMANCE,
 - 2-1.INSERTION FORCE: 5~20N.
 - 2-2.EXTRACTION FORCE: 8~20N.
 - 2-3.DURABILITY: 10000 CYCLES.
- 3.ENVIRONMENTAL PERFORMANCE:

OPERATING TEMPERATURE: -25 $^{\circ}$ C~+85 $^{\circ}$ C.
- 4.IR REFLOW:

THE PEAK TEMPERATURE ON THE BOARD SHALL
BE MAINTAINED FOR 10 SECONDS AT 260 $^{\circ}$ C.
- 5.COMPLIANCE WITH ROHS & HF REQUIREMENTS.
- 6.SALT SPRAY:48H

Ordering Information:

CJ-CF324-013 - 24P - *** - ***
1 2 3

1.Part NO.

2.Finish:

- (Blank): Select Gold:3 μ in[0.076 μ m]Min.
Select Reflowed Gold Flash: 0.6 μ in[0.015 μ m] Min
Overall Nickel Underplate: 50 μ in[1.25 μ m] Min.
G15: Select Gold:15 μ in[0.38 μ m]Min.
Select Reflowed Gold Flash: 0.6 μ in[0.015 μ m] Min
Overall Nickel Underplate: 50 μ in[1.25 μ m] Min.
G30: Select Gold:30 μ in[0.76 μ m]Min.
Select Reflowed Gold Flash: 0.6 μ in[0.015 μ m] Min
Overall Nickel Underplate: 50 μ in[1.25 μ m] Min.

3.Packing:

(Blank): Tape & Reel



Unit	Scale	Sheet	TITLE
mm	1:1	2 of 3	USB4 Type C Female 24Pin Mid-Mount, Offset Height 1.08mm, Dual- Row SMT, CH=0.5mm, L=8.12, Solder TAB=0.8mm
DRAWN	CHK'D	APPR	DRAWING NO.
Haisen Li	Diankui Wan	Jack Yin	
General Tolerances			THIRD ANGLE PROJECTION
x.xx \pm 0.25 x.xxx \pm 0.20 x.xxxx \pm 0.15 ANGLES \pm 1 $^{\circ}$			REV A0
A0	NEW RELEASE	2020.12.15	
REV	DESCRIPTION	DATE	CJ-CF324-013-24P

REV	DESCRIPTION	DATE
A0	NEW RELEASE	2020.12.15
REV	DESCRIPTION	DATE

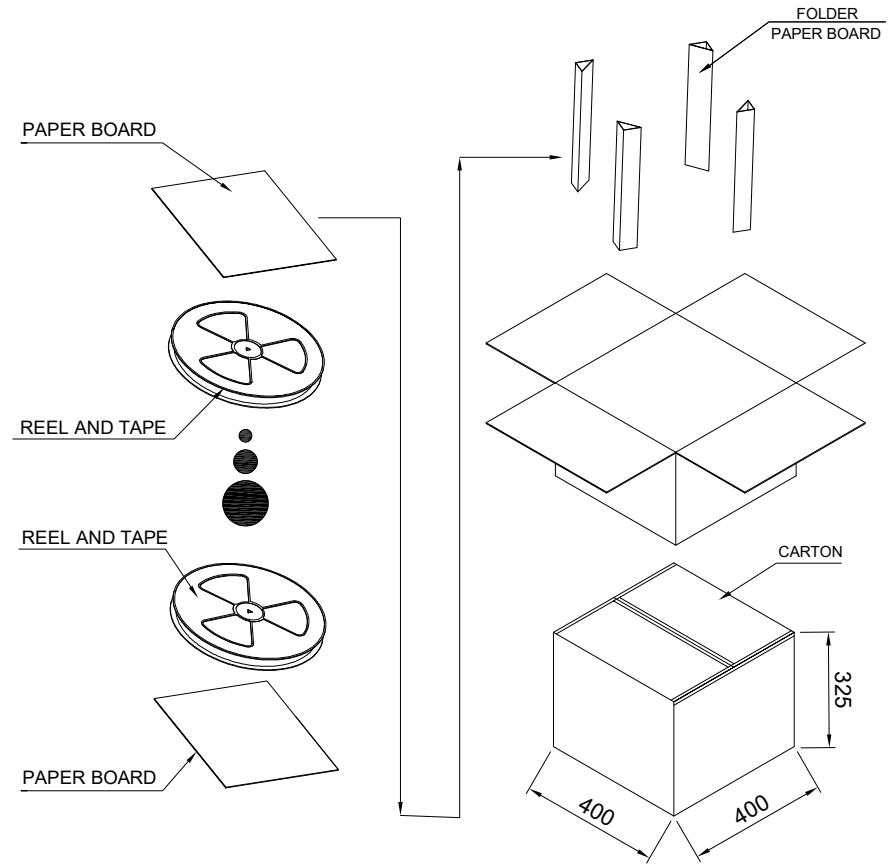
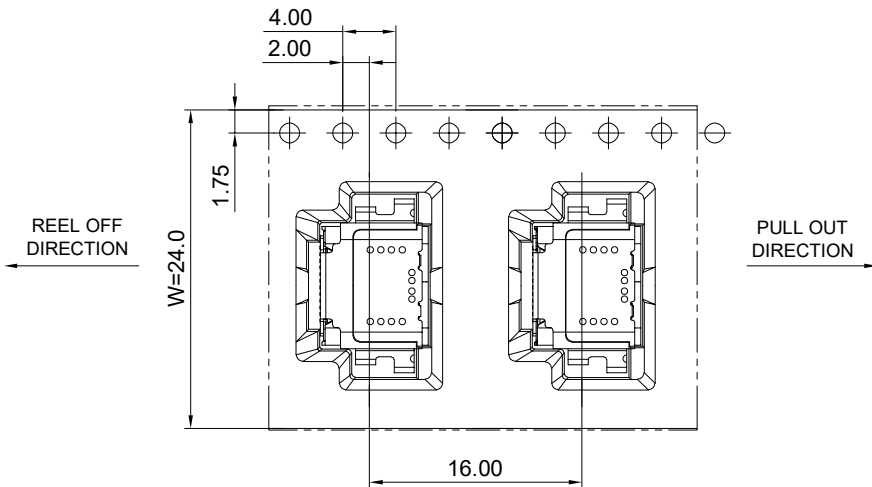
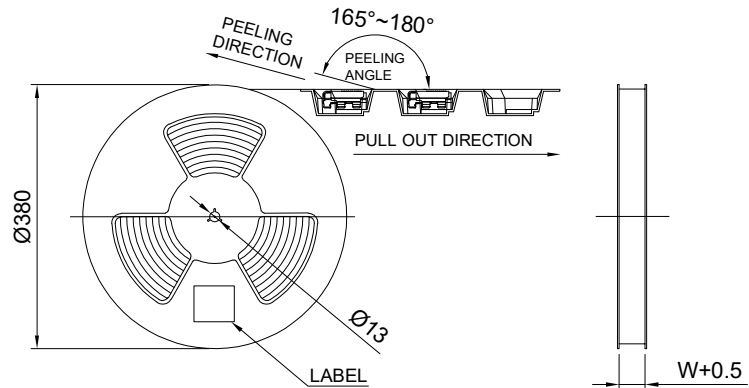
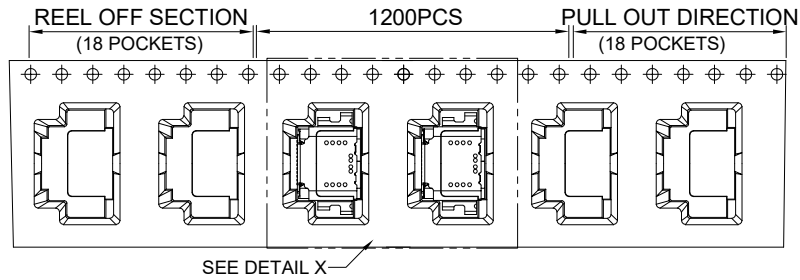

	REEL	CARTON
CONNECTOR (PCS)	1200	12000

CJTconn CHANGJIANG CONNECTORS CO.,LTD.

Unit	Scale	Sheet	TITLE
mm	1:1	3 of 3	
DRAWN	CHK'D	APPR	USB4 Type C Female 24Pin Mid-Mount, Offset Height 1.08mm, Dual- Row SMT, CH=0.5mm, L=8.12, Solder TAB=0.8mm
Haisen Li	Diankui Wan	Jack Yin	
General Tolerances			DRAWING NO.
x.xx±0.25 x.xxx±0.20 x.xxxx±0.15 ANGLES ±1°			
THIRD ANGLE PROJECTION			REV
			A0

REV	DESCRIPTION	DATE
A0	NEW RELEASE	2020.12.15