

P.C.B LAYOUT

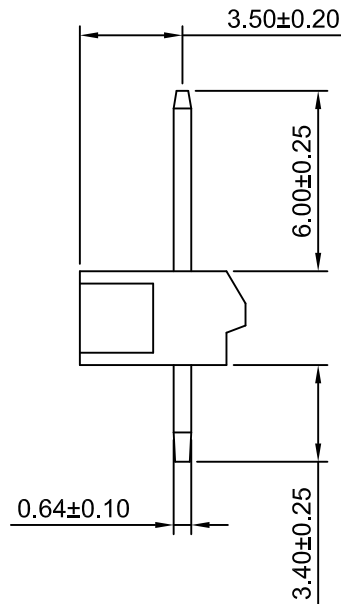
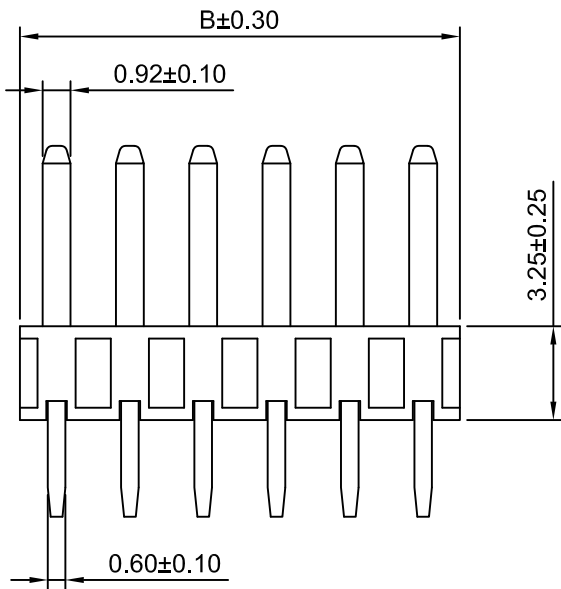

Ordering Information:

A2504WV-XP - \*\*\* - \*\*\* - \*\*\*  
 1 2 3 4

- 1.Part NO.
- 2.Material:  
 (Blank): Nylon 66,UL94V-0(White)  
 LCP: LCP,UL94V-0(Beige)
- 3.Finish:  
 (Blank): Tin over Nickel  
 G: Gold over Nickel
- 4.Color:  
 (Blank): see section 2 material  
 BK: Black

SPECIFICATIONS:

Current Rating: 3A AC,DC  
 Voltage Rating: 250V AC,DC  
 Temperature Range: -40C ~ +105°C  
 Contact Resistance: 15mΩ Max  
 Insulation Resistance: 1000MΩ Min  
 Withstanding Voltage: 1000V AC/minute  
 Pin Material: Brass

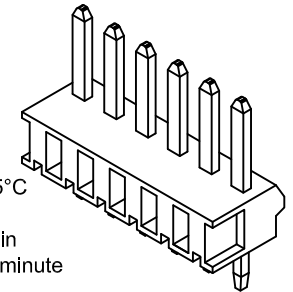

Ordering Information & Dimensions

Circuits	Dimensions(mm)		Circuits	Dimensions(mm)	
	A	B		A	B
2P	2.50	5.00	12P	27.50	30.00
3P	5.00	7.50	13P	30.00	32.50
4P	7.50	10.00	14P	32.50	35.00
5P	10.00	12.50	15P	35.00	37.50
6P	12.50	15.00	16P	37.50	40.00
7P	15.00	17.50	17P	40.00	42.50
8P	17.50	20.00	18P	42.50	45.00
9P	20.00	22.50	19P	45.00	47.50
10P	22.50	25.00	20P	47.50	50.00
11P	25.00	27.50			

**CJTconn** CHANGJIANG CONNECTORS CO.,LTD.

Unit	Scale	Sheet	TITLE
mm	4:1	1 of 1	2.50mm PITCH VERTICAL WAFER
DRWN	CHK'D	APPR	
Chengbiao Ye	Diankui Wan	Jack Yin	

DRAWING NO.	REV
A2504WV-XP	A2

A2	CHANGE THE DRAWING	2023.02.06
A1	CHANGE THE DRAWING	2022.09.15
A0	NEW RELEASE	2005.06.11
REV	DESCRIPTION	DATE

General Tolerances  
 x.xx±0.25  
 x.xxx±0.20  
 x.xxxx±0.15  
 ANGLES ±1°

THIRD ANGLE PROJECTION