

RECOMMENDED PANEL CUT-OUT
(DESIGNED FOR 1.57mm TO 2.30mm THICK
STAMPED PANEL OR PRINTED CIRCUIT BOARD)

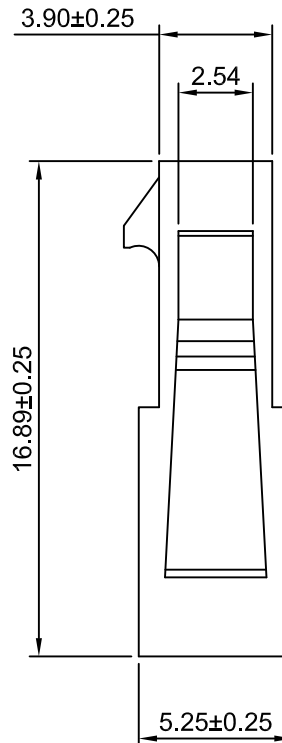
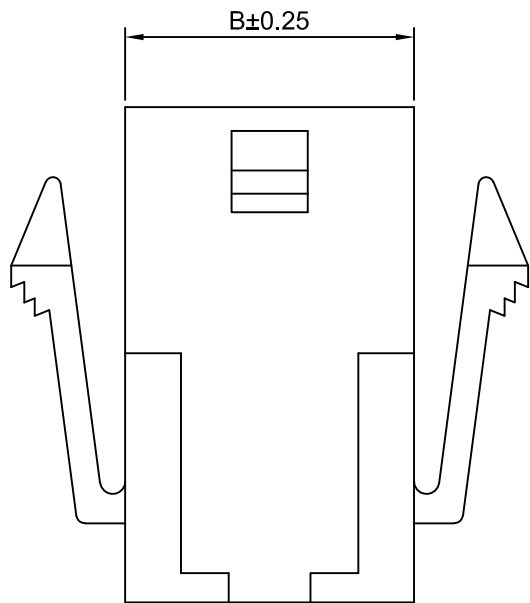
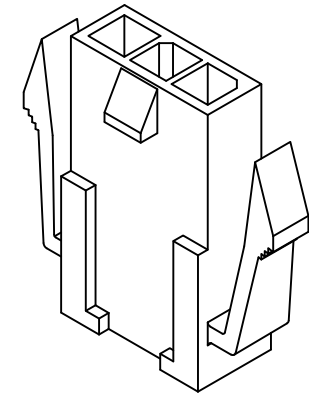

SPECIFICATIONS:

Current Rating: 12.5A AC,DC (AWG #18)
Voltage Rating: 600V AC,DC
Temperature Range: -40°C ~ +105°C
Contact Resistance: 10mΩ Max
Insulation Resistance: 1000MΩ Min
Withstanding Voltage: 1500V AC/minute
Material: Nylon 66,UL94V-0(Black)

Ordering Information & Dimensions

Circuits	Dimensions(mm)		Circuits	Dimensions(mm)	
	A	B		A	B
2P	3.00	6.85	8P	21.00	24.85
3P	6.00	9.85	9P	24.00	27.85
4P	9.00	12.85	10P	27.00	30.85
5P	12.00	15.85	11P	30.00	33.85
6P	15.00	18.85	12P	33.00	36.85
7P	18.00	21.85			

CJTconn CHANGJIANG CONNECTORS CO.,LTD.

Unit	Scale	Sheet	TITLE
mm	4:1	1 of 1	3.00mm PITCH
DRWN	CHK'D	APPR	SINGLE ROW HOUSING
Xu Lei	Djankui Wan	Jack Yin	
General Tolerances			THIRD ANGLE PROJECTION
x.xx±0.25 x.xxx±0.20 x.xxxx±0.15 ANGLES ±1°			DRAWING NO.
			C3030HM-XP
			REV A2

REV	DESCRIPTION	DATE
A2	CHANGE THE DRAWING	2022.01.14
A1	CHANGE THE Current Rating	2018.12.15
A0	NEW RELEASE	2005.05.10