

SEC:A-A

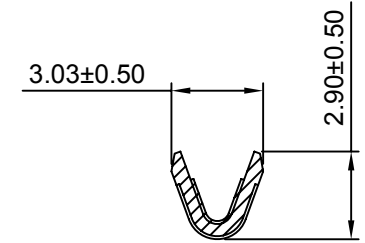

SEC:B-B

Ordering information & Specifications

Unit:mm

| Part No        | Wire Range | Insultion O.D. | Material | Finish          | Qty/reel  |
|----------------|------------|----------------|----------|-----------------|-----------|
| A7501AM-TB-LL  | AWG#18~#20 | 3.30mm(max)    | Brass    | Tin over Nickel | 5,000 PCS |
| A7501AM-TBS-LL | AWG#18~#20 | 3.30mm(max)    | Brass    | Unplated        | 5,000 PCS |

**CJTconn**

CHANGJIANG CONNECTORS CO.,LTD.

|      |       |        |
|------|-------|--------|
| Unit | Scale | Sheet  |
| mm   | 4:1   | 1 of 1 |

Title :

7.50mm PITCH

Draw BY:  
Tony Su

Approved :  
Jack Yin

CRIMP TERMINAL

General Tolerance

x.xx±0.25  
x.xx±0.20  
x.xxx±0.15

ANGLE±

| REV | DESCRIPTION | DATE       |
|-----|-------------|------------|
| A0  | NEW RELEASE | 2017.07.24 |

DRAW NO : A7501AM-T-LL

REV  
A0